

INSTALLATION INSTRUCTIONS

MANUAL PRIMARY CHAIN ADJUSTER

ATTENTION INSTALLER (if other than owner): Please forward this instruction sheet to the purchaser of this product. These instructions contain valuable information necessary to the end user.

INTRODUCTION: These instructions describe the procedure for properly installing the manual primary chain adjuster on all 06-17 Dyna, 07-17 Softails and 07-16 Touring models.

Review instructions carefully before beginning, as they contain important information. Please retain for future reference.

Particularly important information is distinguished in these instructions by the following notations:

NOTE: A **NOTE** provides key information to make procedures easier or clearer.

CAUTION: A **CAUTION** indicates special procedures that must be followed to avoid damage to the motorcycle and/or accessories.

WARNING!: A **WARNING!** indicates special procedures that must be followed to avoid injury to a motorcycle operator or person inspecting or repairing the motorcycle.

PROCEDURE:

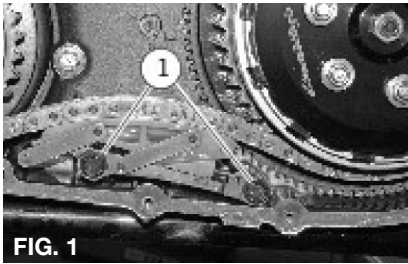
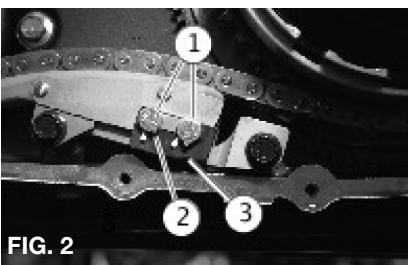
1. Remove seat.
2. Disconnect negative battery cable.
3. Drain primary lubricant and remove primary cover.
4. See **FIGURE 1**. Remove two screws with the original automatic tensioner from the primary case. Remove the tensioner. Save the two screws.
5. Install the lower adjuster from the kit using the two mounting screws from the original tensioner.  **FIG. 1**
6. See **FIGURE 2**. Install the upper adjuster with shoe. Install the two hex cap screws (1) through the lock plate (2) and the side plate (3) and loosely assemble the upper adjuster.  **FIG. 2**
7. Check the primary chain tension. Push on the upper chain row to verify that it has free up-and-down movement midway between the engine compensating sprocket (front) and the clutch sprocket (rear).
8. Measure the free play to be sure that it falls within the range



specified for a hot or cold engine: Cold Engine $\frac{5}{8}$ "- $\frac{7}{8}$ " inch; Hot Engine $\frac{3}{8}$ "- $\frac{5}{8}$ " inch.

9. See **FIGURE 3** and Exploded View. Using a ball end hex driver for the socket head cap screw, adjust the chain tension to specifications.

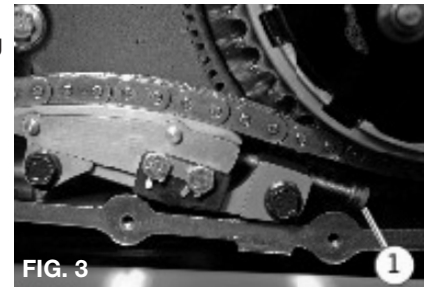

10. Tighten side plate screws to 55-60 in.-lbs. Bend a tab of the lock plate for each hex cap screw, choosing a tab that is closest to flat on head of the hex cap screw.

11. Remove the adjuster screw (4) after tightening and save the screw to reuse. **DO NOT** run the engine with the screw installed.

CAUTION: To prevent primary drive damage, remove adjustment screw from tensioner when adjustment is complete.

NOTE: As chains stretch and wear, they run tighter at one spot than another. Always adjust the free play at the tightest spot in the chain. Replace the primary chain if it is worn to the point where it cannot be properly adjusted. Always keep the primary chain properly adjusted. Allowing the chain to run too tight or too loose will result in excessive chain and sprocket wear.

12. Replace the primary cover and fill with lubricant as needed.
13. Connect negative cable to battery.
14. Install seat.

WARNING!: Before operating motorcycle, be sure all hardware is tight.

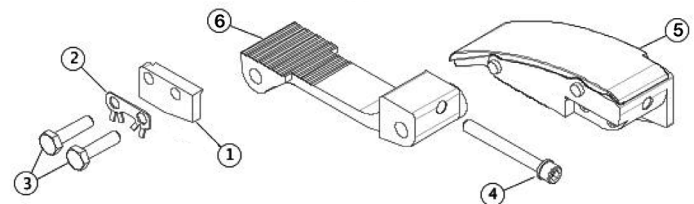

EXPLODED VIEW

- | | |
|-----------------------|---------------------------------------|
| 1. Side Plate | 4. Hex Socket Head Cap Screw |
| 2. Lock Plate | 5. Upper Adjuster with Tensioner shoe |
| 3. Hex Cap Screws (2) | 6. Lower adjuster |