



CIRO SADDLEBAG EXTENSIONS

Parts Included:

- 1 Left Saddlebag Extension
- 1 Right Saddlebag Extension
- 1 Hardware Kit Including:
 - 8 Adhesive Backed Cable Tie Mounts
 - 10 6" Cable Ties
 - 12 1/4" Flat Washers
 - 6 1/4-20 x 3/4" Bolts
 - 6 1/4-20 Nylon-Insert Locknuts
 - 1 Dielectric Grease Packet
 - 1 Wiring Adapter

Installation Instructions:

1. Park on a level surface and shut off the bike.
Ensure that the engine has had time to cool before installation.
2. Remove left and right saddlebags. Ensure that you have somewhere clean and non-abrasive to set them.
3. Clean the bottoms of the bags, where you will be mounting the **Ciro Saddlebag Extensions**, with an ammonia based glass cleaner to remove any wax or contaminants. This will ensure a strong bond between the bags and extensions. Wipe saddlebag extensions clean of any packaging residue using ammonia based glass cleaner and a soft cloth.
4. Test fit the saddlebag extensions making sure to note left and right. The part should fit to the side and back of your bag, leaving no gap. Place blue tape under the mounting holes in the general location. Next, use a center punch to mark the center of the holes for drilling.



WARNING:

This indication alerts you to the fact that ignoring the contents described herein can result in potential serious injury or death if not followed.

CAUTION:

This indication alerts you to the fact that ignoring the contents described herein can or will result in material damage and/or personal injury.

ATTENTION:

This indication alerts you to the fact if you ignore this detail you will affect the performance or functionality of the product.

All **Ciro** products are designed for "easy assembly" and/or "plug and play". We recommend a competent mechanic install our products, using standard mechanical procedures to assure a safe and successful installation.

NOTE:

Ciro products are designed and manufactured under very strict quality control. **Ciro** warrants that products sold to the original purchaser shall be free from any defects in materials and workmanship for a period of 3 (three) years from the date of purchase, and a lifetime warranty against LED failure. **Ciro** will have no obligation if the customer cannot show proof of purchase. Warranty will not be granted unless the part is properly installed and maintained. **Ciro** will not be liable for any consequential and incidental damages, including labor, or non-**Ciro** products. Please visit our website Ciro3d.com for our complete warranty policy.

CIRO3D.COM

5. Use a small drill bit to make a pilot hole in the previously marked locations, then use a 9/32" bit to drill out the holes to the correct size.

6. Use a knife or files to clean up the holes and remove any burrs. This will ensure a flush fit between the bag and extensions.

7. Use your fingernail to rub the backing of the double sided tape to activate the adhesive. Next, peel the backing and carefully align the corner of the extension with the corner of your bag. Make sure there is no gap, and that the holes in the extension line up with the holes in your bag.

8. Lay the bag on its side, using something to prop the lid open:



9. Put a bolt and washer through from the inside, then use a washer and nut to fasten it from the outside, for all three holes.

10. Pressing the extension against the bag, tighten down the bolts using a 5/32" allen and a 7/16" wrench. Do not over-tighten as this will cause damage.

11. Test fit the inner filler piece, and route the wire in the crevice as shown below. Activate the adhesive, and apply the inner filler piece to the bag, making sure the wire stays in place.

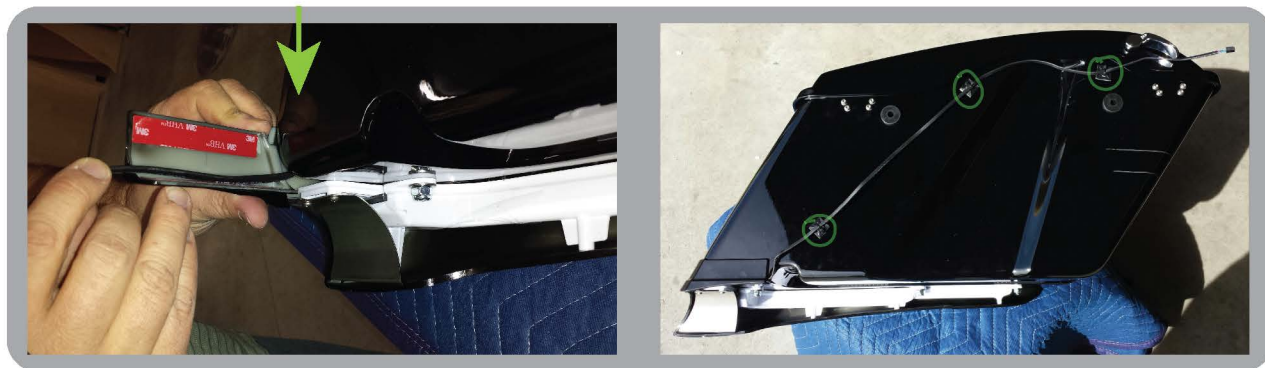

12. Peel the backing off of the cable tie mounts, and place them in the locations shown above. Secure the wire to the mounts using the included cable ties. Be sure to route the wire away from any hot or moving parts.

13. Put the saddlebags back on your motorcycle, keeping the wire lead exposed so you are able to plug it in.

14. Locate and disconnect the black, rear lighting wiring harness. It is located under the seat towards the rear of the motorcycle.

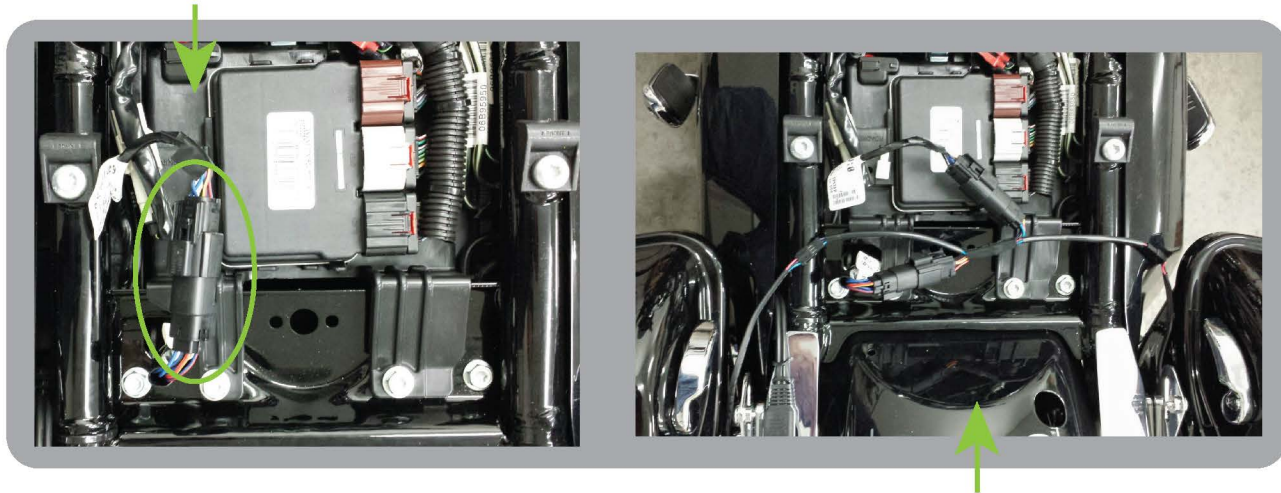

14. Plug the included wiring adapter in-line with the rear lighting wiring harness.

15. Plug the wires from the saddlebag extension into the wiring adapter with the brown wire on the right and the violet wire on the left.

16. Turn the switch on to the accessory position and test that all light functions are working correctly.