



BAT BLADES® '14-UP

Parts Included:

- 1 Right Bat Blade
- 1 Left Bat Blade
- 2 Y-Harnesses
- 1 Dielectric Grease Packet
- 6 6" Cable Ties

Installation Instructions:

1. Park on a level surface and shut off the motorcycle. Ensure that the engine has had time to cool before installation.
2. Use an ammonia-based glass cleaner to remove any wax or contaminants on the fairing where Bat Blades will be installed.
3. Locate small R and L on each Bat Blade to determine right and left side.
4. Align wire end of strip to bottom of fairing and temporarily hold strip in place with painter's tape. Once both Bat Blades are in place, step back and be sure that they are evenly placed. Once you are satisfied with placement, put a small piece of tape at the top of each strip on the fairing. This tape marker will ensure proper placement once adhesive backing is removed.
5. Remove adhesive backing and align strip according to your painter's tape mark. Press and hold firmly for 60 seconds. Adhesive fully cures within 24 hours.
6. Remove turn signal bar and unplug. Apply a small amount of the included dielectric grease to the connector and plug the y-harness in line with it. Connect Bat Blade wire in line with y-harness. Secure excess wire with included cable ties inside of frame.

Tuck wires in

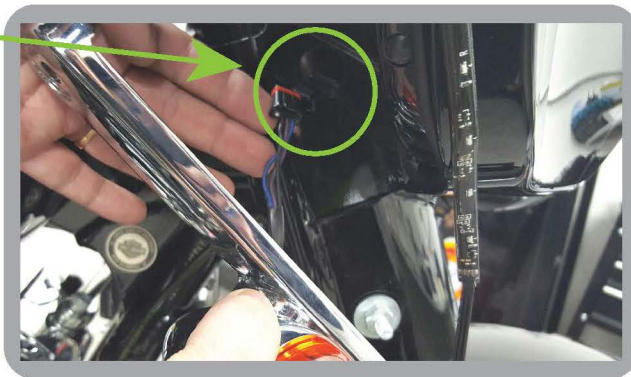

7. Reinstall turn signal bar ensuring no wires are pinched. Repeat steps 5-7 on opposite side.
8. Turn on power to verify that Bat Blades are functioning correctly, then torque acorn nuts on turn signal bar to 120-180 in-lbs.

WARNING:

This indication alerts you to the fact that ignoring the contents described herein can result in potential serious injury or death if not followed.

CAUTION:

This indication alerts you to the fact that ignoring the contents described herein can or will result in material damage and/or personal injury.

ATTENTION:

This indication alerts you to the fact if you ignore this detail you will affect the performance or functionality of the product.

All Ciró products are designed for "easy assembly" and/or "plug and play". We recommend a competent mechanic install our products, using standard mechanical procedures to assure a safe and successful installation.

NOTE:

Ciró products are designed and manufactured under very strict quality control. Ciró warrants that products sold to the original purchaser shall be free from any defects in materials and workmanship for a period of 3 (three) years from the date of purchase, and a lifetime warranty against LED failure. Ciró will have no obligation if the customer cannot show proof of purchase. Warranty will not be granted unless the part is properly installed and maintained. Ciró will not be liable for any consequential and incidental damages, including labor, or non-Ciró products. Please visit our website Ciro3d.com for our complete warranty policy.

CIRO3D.COM