



CIRO CLAMP MOUNT

PARTS INCLUDED

1	Clamp half male
1	Clamp half female
1	Ball post
1	1/4-20 x 3/4" SHCS
*1	Reducer ring

INSTALLATION INSTRUCTIONS:

1. Park on a level surface and shut off the motorcycle. Ensure that the engine has time to cool before installation.
2. Determine the ideal location for the device you are mounting with the *Ciro Clamp Mount*.
NOTE: Avoid tubing bends. Place the clamp on straight sections only.
NOTE: Tightening this clamp onto a bar might mark the surface finish.
- *3. Optional step. If you are using the clamp on a 7/8" or 1 1/8" bar open up the reducer ring and form it around the bar before installing the clamp.
4. Assemble the clamp halves around the bar and insert the 1/4-20 screw through both halves. Thread the ball post onto the screw. Align the flat spot toward the hinge of the clamp.
5. Tighten the assembly "finger tight" and fine tune the position.
6. Finally tighten the assembly onto the bar using a 3/16" hex key in the screw and another 3/16" hex key in the ball stud. Tighten the screw until the clamp is tight. **Do not overtighten.** This clamp will hold securely with minimal screw torque.
ATTENTION: There will be a small gap between the clamp halves when it is properly installed.
ATTENTION: Torque must not exceed 48 in-lbs (4 ft-lb).

NOTE: If you have purchased a *Ciro* accessory to go with your *Clamp Mount*, please refer to those instructions to complete your installation.

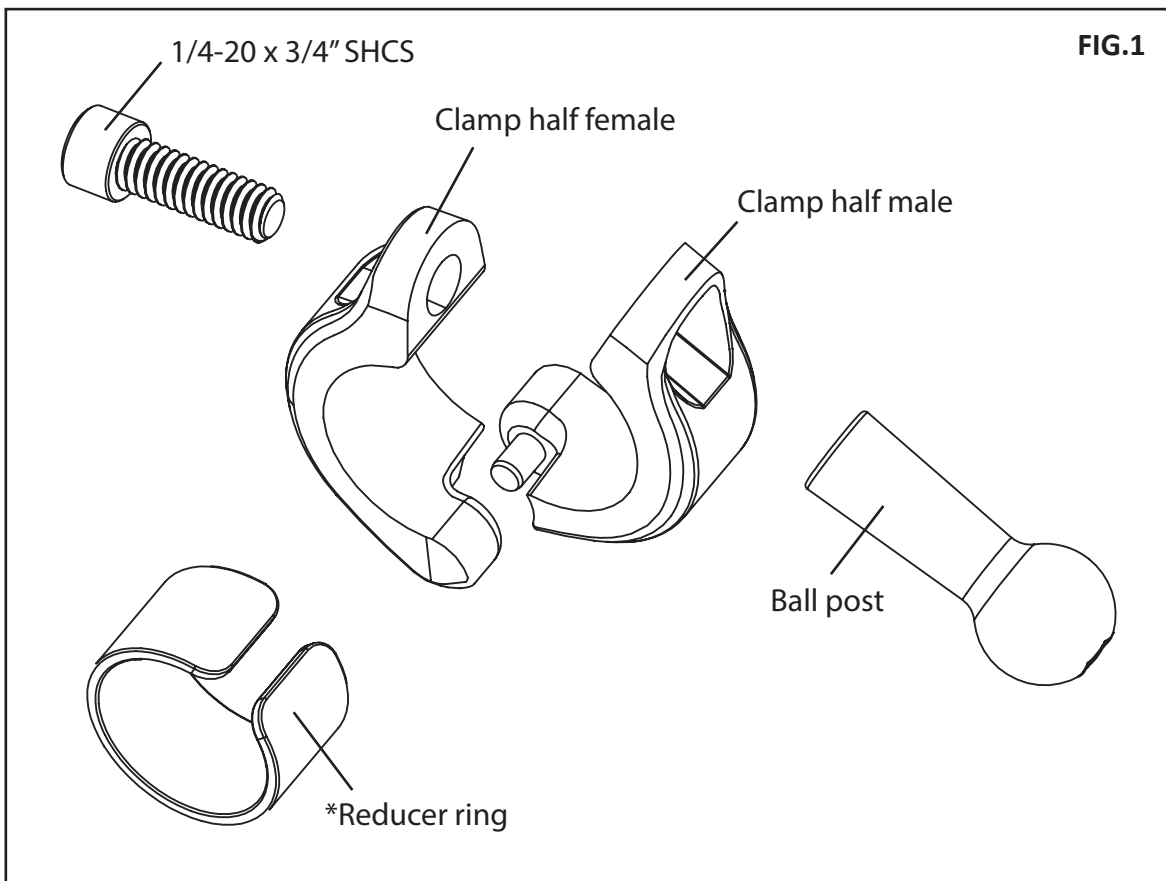

FIG.1

WARNING:

This indication alerts you to the fact that ignoring the contents described herein can result in potential serious injury or death if not followed.

CAUTION:

This indication alerts you to the fact that ignoring the contents described herein can or will result in material damage and/or personal injury.

ATTENTION:

This indication alerts you to the fact if you ignore this detail you will affect the performance or functionality of the product.

All *Ciro* products are designed for "easy assembly" and/or "plug and play". We recommend a competent mechanic install our products, using standard mechanical procedures to assure a safe and successful installation.

NOTE:

Ciro® warrants that products sold hereunder to the original purchaser, if maintained and operated under normal conditions, shall be free from any defects in materials and workmanship for a period of (3) years from date of purchase, and a lifetime warranty against LED failure.

Ciro will have no obligation if the customer cannot show proof of purchase.

Warranty will not be granted unless the part is properly installed and maintained.

Ciro will not be liable for any consequential and incidental damages, including labor, or non-*Ciro* products.

Please visit our website Ciro3d.com for our complete warranty policy.