



CIRO ALUMINUM CLAMP MOUNT

PARTS INCLUDED

1	Clamp half male
1	Clamp half female
1	Ball post
1	1/4-20 x 3/4" SHCS
*1	Reducer ring (*7/8"-1" kits only)

INSTALLATION INSTRUCTIONS:

1. Park on a level surface and shut off the motorcycle. Ensure that the engine has time to cool before installation.
2. Determine the ideal location for the device you are mounting with the *Ciro Clamp Mount*.
NOTE: Tightening this clamp onto a bar will mark the surface finish.
- *3. Optional step. If you are using the clamp on a 7/8" bar open up the reducer ring and form it around the bar before installing the clamp.
4. Assemble the clamp halves around the bar and insert the 1/4-20 screw through both halves. Thread the ball post onto the screw. Align the flat spot toward the hinge of the clamp.
5. Tighten the assembly "finger tight" and fine tune the position.
6. Finally tighten the assembly onto the bar using a 3/16" hex key in the screw and another 3/16" hex key in the ball stud. Torque to 10 ft-lbs.

NOTE: If you have purchased a *Ciro* accessory to go with your *Clamp Mount*, please refer to those instructions to complete your installation.

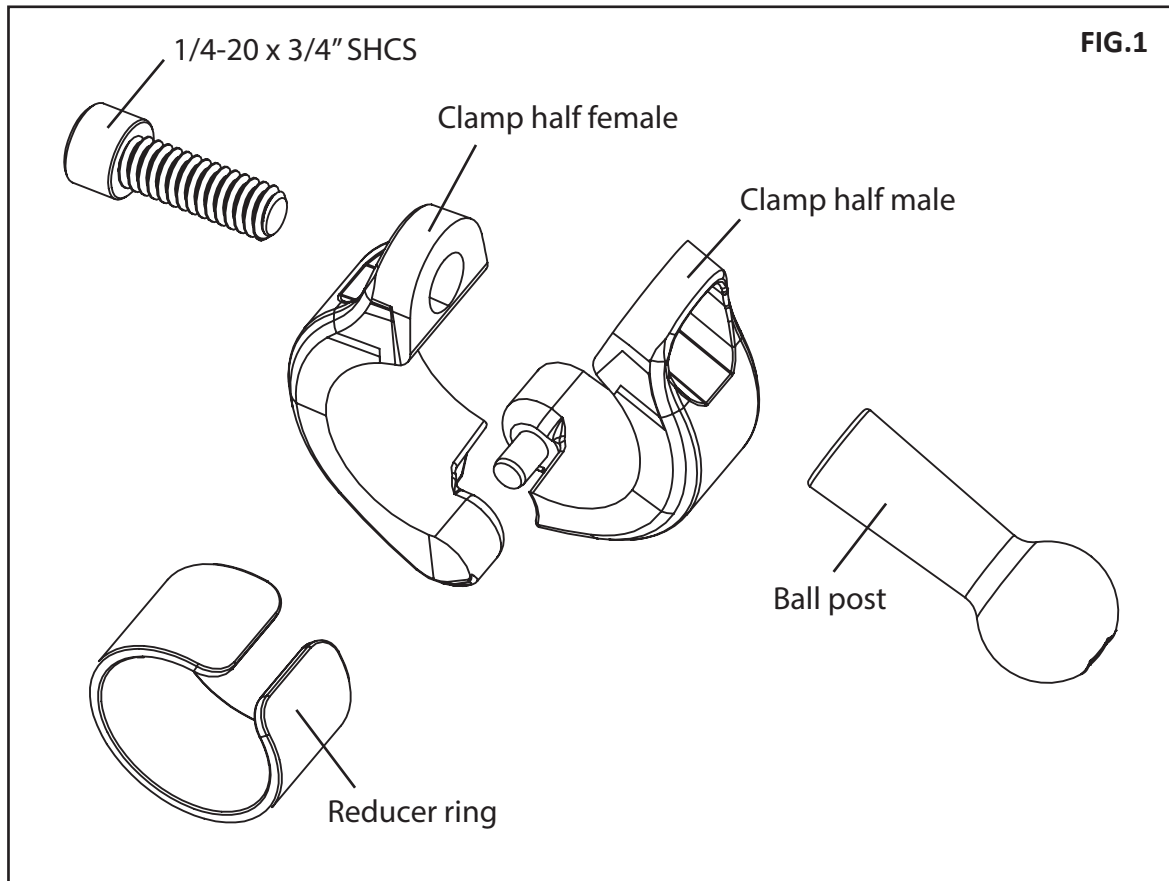

FIG.1

WARNING:

This indication alerts you to the fact that ignoring the contents described herein can result in potential serious injury or death if not followed.

CAUTION:

This indication alerts you to the fact that ignoring the contents described herein can or will result in material damage and/or personal injury.

ATTENTION:

This indication alerts you to the fact if you ignore this detail you will affect the performance or functionality of the product.

All *Ciro* products are designed for "easy assembly" and/or "plug and play". We recommend a competent mechanic install our products, using standard mechanical procedures to assure a safe and successful installation.

NOTE:

Ciro® warrants that products sold hereunder to the original purchaser, if maintained and operated under normal conditions, shall be free from any defects in materials and workmanship for a period of (3) years from date of purchase, and a lifetime warranty against LED failure.

Ciro will have no obligation if the customer cannot show proof of purchase.

Warranty will not be granted unless the part is properly installed and maintained.

Ciro will not be liable for any consequential and incidental damages, including labor, or non-*Ciro* products.

Please visit our website Ciro3d.com for our complete warranty policy.



SMARTPHONE HOLDER

Parts Included:

- 1 Smartphone Holder Assembly
- 1 Wiring Harness (**Powered Model Only**)

Installation Instructions:

1. Remove the large plastic nut from your smartphone holder and slide it over the **Ciro** ball mount with the threads facing outward.

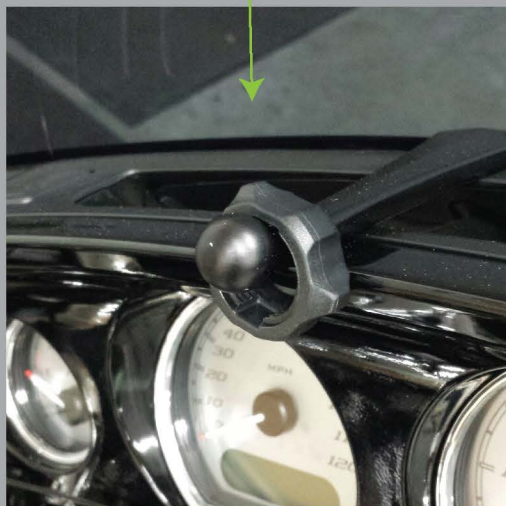

2. Snap your smartphone holder onto the ball and thread the large plastic nut onto the drink holder. Adjust the angle and tighten it down.

3. Flip up the side lever on the smartphone holder and adjust it to the size of your phone. Your device should have just enough space to slide in and out. When adjusted correctly, flip the lever down to secure your device.

***Note:** The lever can be put on either side if unscrewed all the way.

[Powered Model Only]

- 4: Connect the included wiring harness to your battery and route the wires to where you have mounted the smartphone holder. Plug the power jack into the phone holder and then your USB cable into the holder and device.

***Note:** USB cable not included

WARNING:

This indication alerts you to the fact that ignoring the contents described herein can result in potential serious injury or death if not followed.

CAUTION:

This indication alerts you to the fact that ignoring the contents described herein can or will result in material damage and/or personal injury.

ATTENTION:

This indication alerts you to the fact if you ignore this detail you will affect the performance or functionality of the product.

All **Ciro** products are designed for "easy assembly" and/or "plug and play". We recommend a competent mechanic install our products, using standard mechanical procedures to assure a safe and successful installation.

NOTE:

Ciro products are designed and manufactured under very strict quality control. **Ciro** warrants that products sold to the original purchaser shall be free from any defects in materials and workmanship for a period of 3 (three) years from the date of purchase, and a lifetime warranty against LED failure.

Ciro will have no obligation if the customer cannot show proof of purchase.

Warranty will not be granted unless the part is properly installed and maintained.

Ciro will not be liable for any consequential and incidental damages, including labor, or non-**Ciro** products.

Please visit our website Ciro3d.com for our complete warranty policy.

CIRO3D.COM