



FRAME MOUNTED ADJUSTABLE HIGHWAY PEG MOUNTS

- WARNING** This indication alerts you to the fact that ignoring the contents described herein can result in potential serious injury or death if not followed.
- CAUTION** This indication alerts you to the fact that ignoring the contents described herein can or will result in material damage and/or personal injury.
- ATTENTION** This indication alerts you to the fact if you ignore this detail you will affect the performance or functionality of the product.

All Ciro products are designed for "easy assembly" and/or "plug and play". We recommend a competent mechanic install our products, using standard mechanical procedures to assure a safe and successful installation. Read completely and understand the instructions prior to starting installation.

NOTE: Ciro products are designed and manufactured under very strict quality control. Ciro warrants that products sold to the original purchaser shall be free from any defects in materials and workmanship for a period of 3 (three) years from the date of purchase, and a limited lifetime warranty against LED failure. Ciro will have no obligation if the customer cannot show proof of purchase. Warranty will not be granted unless the part is properly installed, unmodified and maintained. Ciro will not be liable for any consequential and incidental damages, including labor, or non-Ciro products. Please visit Ciro3d.com for our complete warranty policy.



Included Items:

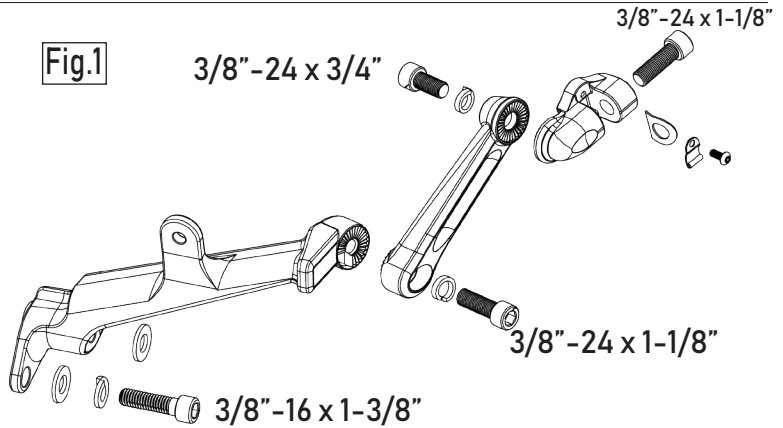

Fig.1

Installation Instructions:

1. Park on a level surface and shut off the motorcycle. Ensure the engine has time to cool before installation.
2. Starting on the right side, lift the floorboard and remove the front floorboard pivot bolt using a 3/16" hex wrench and a 7/8" box wrench. Set aside for reuse. Fig. 2
3. Note the OEM bolt to be removed and the rear mount support screw to be loosened. Loosening the rear bolt will help alleviate any binding issues when new mount is put in place. Fig. 3
4. Remove OEM bolt and set aside with OEM mount arm. Fig.4
5. Add provided flat washer to OEM bolt with lock washer and place through center hole in the mount arm. The side tab should align with the threaded hole shown in Fig. 4. Use provided 3/8"-16 x 1-3/8" bolt with lock washer and flat washer. Make sure upper tab is between guides on floorboard as shown in Fig. 2. Tighten all bolts to factory torque specs. Fig. 5
6. Position arm extension as shown in Fig. 6 and insert bolt with lock washer but do not tighten fully.
7. Position clevis at end of arm and attach with provided bolt and lock washer. Bolt and spring tab are preinstalled and the right side will have those positioned at the top of the clevis. Loosely tighten bolt.



Fig.2

Fig.3

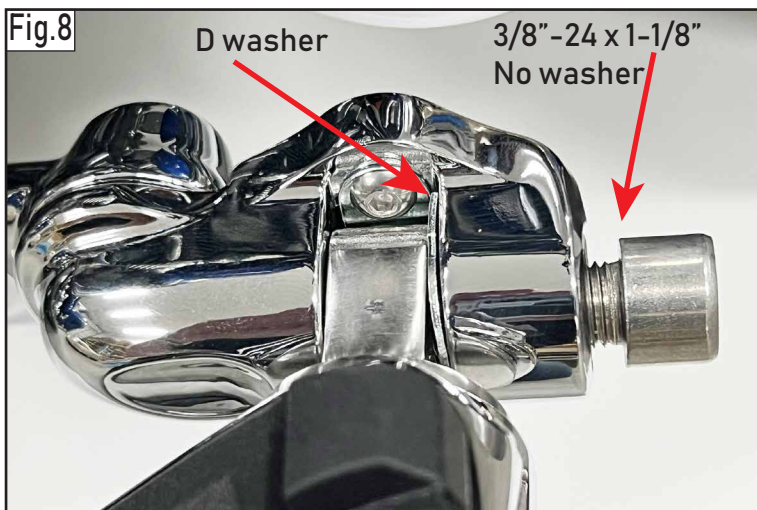
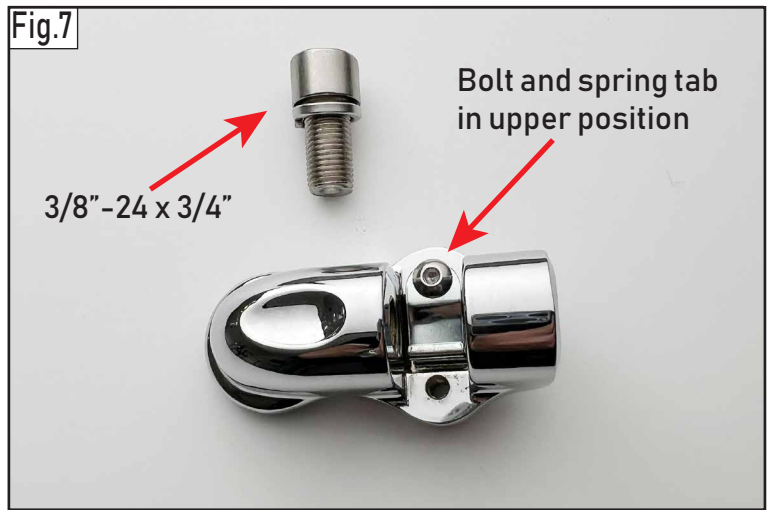
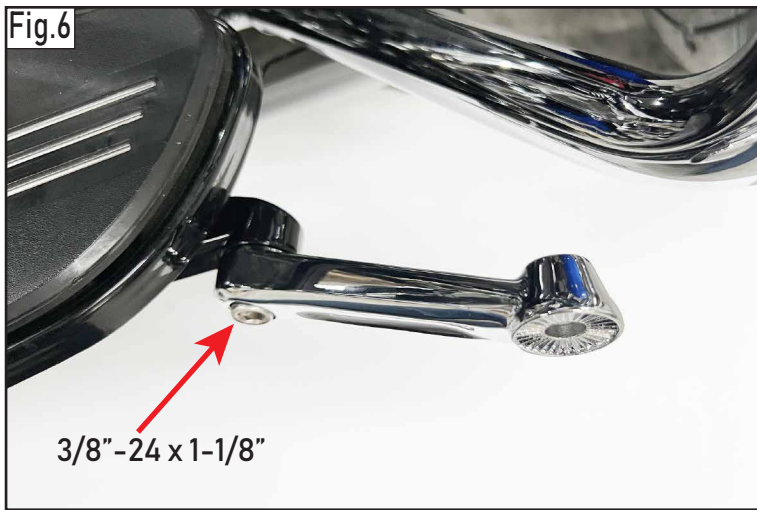
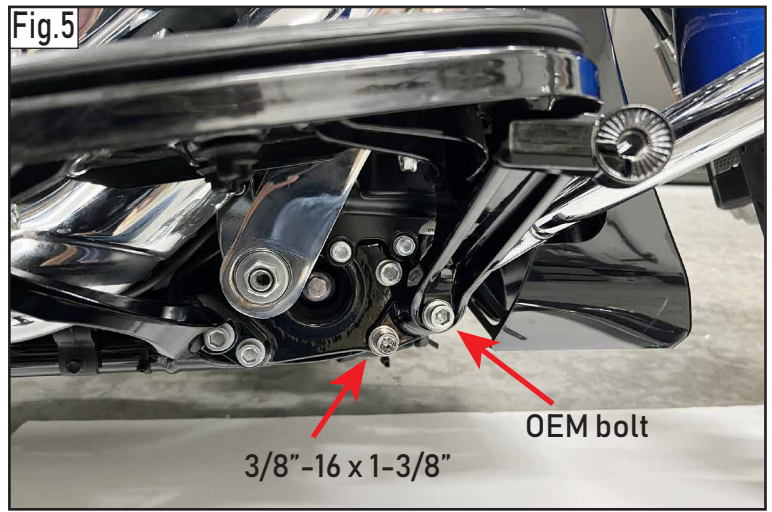
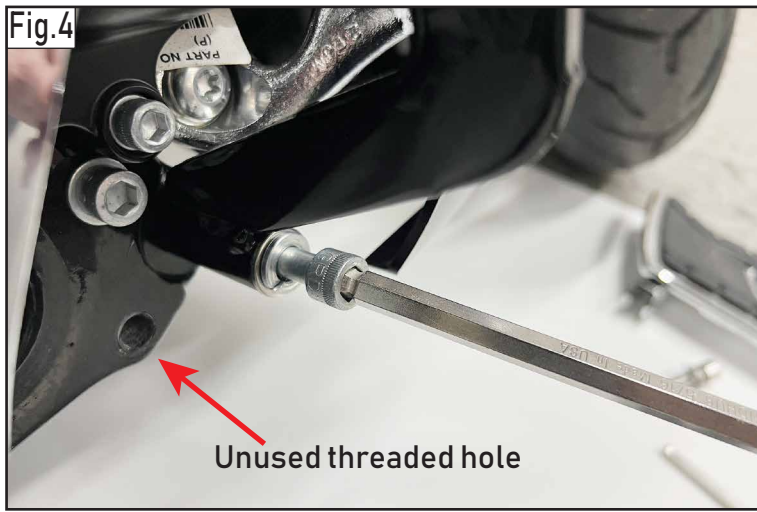

8. Add peg of your choice with 1/2" adapter to the clevis using the D spring washer with the flat side toward the inside. Fig. 8 Insert the bolt into the clevis without a washer and tighten securely.

9. Test position of components while sitting on the bike, adjust as necessary using the three points of adjustment shown in Fig.9. Tighten all screws securely.

10. Repeat steps 2-9 on other side of motorcycle.

NOTE: We recommend the use of a medium strength thread locker on all bolts.