



Items Supplied >

| DESCRIPTION: | QUANTITY: |
|-------------------------------------|-----------|
| 1. Sissy Bar with Pad and Insert | x1 |
| 2. Side Plates (Left/Right) | x2 |
| 3. 5/16" Thick Black Spacers | x4 |
| 4. M8-1.25 x 20mm Button Head Bolts | x4 |
| 5. M8-1.25 x 25mm Button Head Bolts | x4 |

Application(s) >

| MAKE: | MODEL: | YEAR: |
|-------|------------|-------|
| HONDA | REBEL 1100 | 21-23 |

NOTE: NOT COMPATIBLE WITH SADDLEBAGS.

Instruction Manual >

02-8609B

Page 1 of 2

Read all instructions carefully before installing your new Cobra® product!

1. Remove the stock rear fender bolts from the left and right-side fender rails and discard.
2. Apply blue Loctite to all four of the supplied M8 x 25mm bolts and then install the sissy bar brackets onto the motorcycle by inserting the bolts through the side brackets, through the provided spacers, and into the threaded bosses on the frame rail. Make sure that the part numbers on the brackets are facing inward. Snug the bolts but **DO NOT TIGHTEN** at this time. See **FIGURE 1**.
3. Install the sissy bar with pad onto the supplied side brackets with the four M8 X 20mm button head bolts. Snug the bolts but **DO NOT TIGHTEN** at this time. See **FIGURE 1**.
4. Pull backward on the top of the sissy bar and tighten all four M8 X 20mm bolts. See **FIGURE 1**.
5. Tighten all four M8 x 25mm bolts and check that the sissy bar is secure.
6. Check the tightness of all (8) bolts after the first ride, after the first 500 miles, and at every engine service thereafter.

** Cobra® recommends you always wear a helmet while riding. Please never operate your motorcycle while under the influence of alcohol and/or drugs. Enjoy the new look of your motorcycle and please ride safely.*

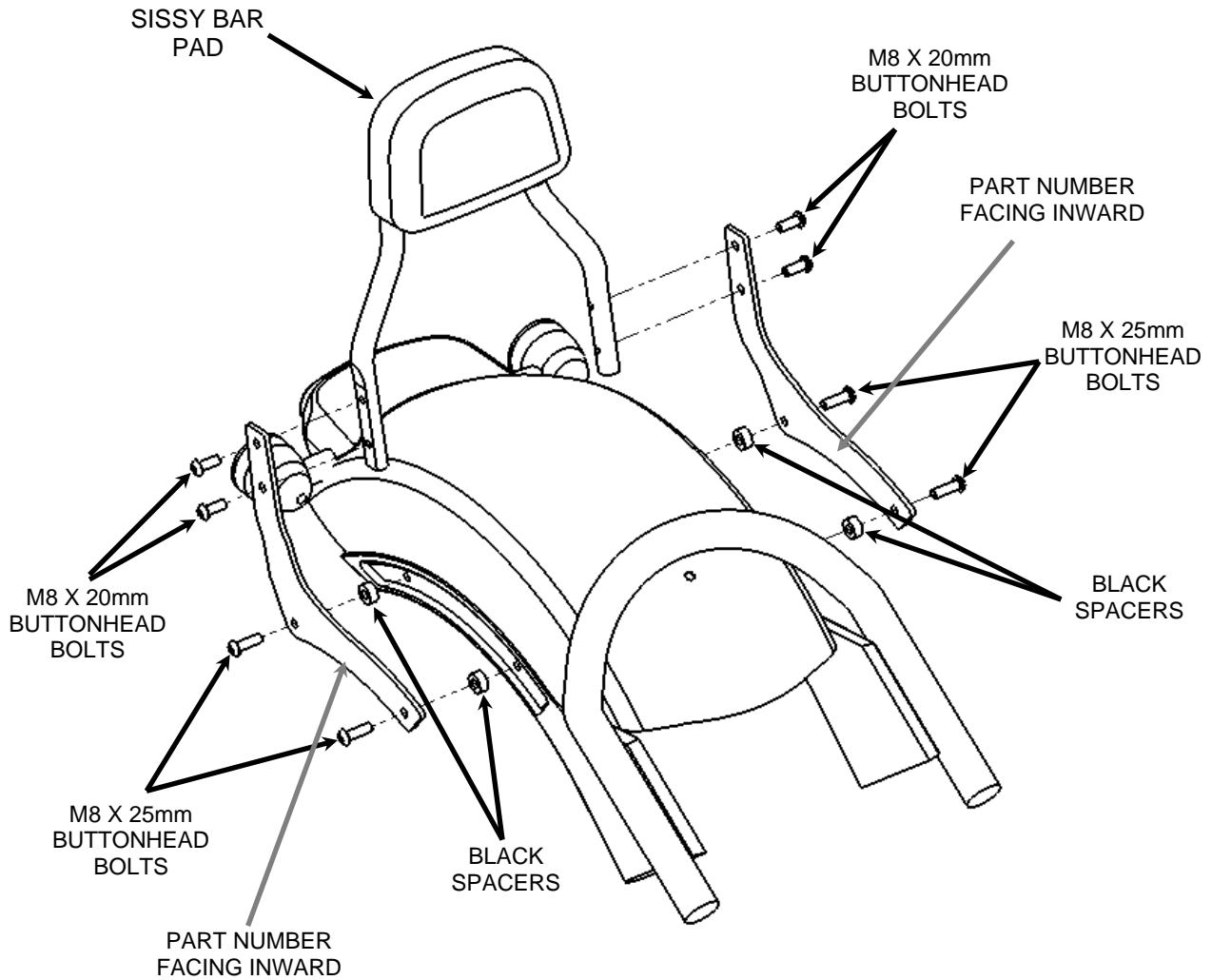

FIGURE 1

To clean your black accessory use a liquid based soap detergent, such as dishwashing soap applied with a soft cloth and rinse with clean water. Note: Avoid abrasive cleaning methods such as granular or dry cleansers, simple green, Scotch-Brite or steel wool pads. Abrasives may breach the coating and shorten life.