



HogLIGHTS

CAN YOU SEE ME NOW
ARSEHOLE!

5.75' Yamaha HogLight Installation Instructions

Thank you for choosing HogLights

We know you would rather be riding your bike than working on it, so we make our instructions clear and easy to understand. If you have any questions, comments, or suggestions don't hesitate to give our brilliant experts a call on +61 7 3350 3000

Please Read Before Installing

If you are unsure of your ability to properly install a product, please have the product installed by your local motorcycle technician. HogLights takes no responsibility for damages caused by improper installation.

Caution: When installing electronics it is extremely important to pay close attention to how wires are routed, especially when mounting products to the front fender, front forks, or fairing of your motorcycle.

Always be sure to turn the handlebars fully left, fully right, and fully compress the suspension to ensure the wires will not bind and have enough slack for your motorcycle to operate properly.

Installation Tips

We strongly recommend using medium strength liquid thread locker on all screws, nuts, and bolts. It is also important to ensure that all hardware is tightened to the proper torque specifications as listed in your owner's manual. Recheck your torque specifications after the first 50Kkm to ensure they remain correct.

Kit Contents		Tools you will need
• Yamaha 5.75" HogLight	Qty 1	• 4mm Allen Key
• Bracket (HLA-YM-R1)	Qty 1	• 2.5mm Allen Key
• M4x20	Qty 3	• 10mm Wrench
• M6x14	Qty 2	• Phillips Head Screwdriver
• Metal Bushing, 12mm to 6mm	Qty 2	
• M6 Nut	Qty 2	
• M6 Washer	Qty 2	
• M6 Lock Washer	Qty 2	
• Quick Splice Connector (Red)	Qty 1	



HogLIGHTS

CAN YOU SEE ME NOW
ARSEHOLE!

Mounting the Bracket

Use the M4x20 bolts to bolt bracket to the rear of the LED headlight module.

Installing the LED Module

Disassemble the head light bucket as per the manufacturer's instructions and remove the OEM sealed beam unit.

Remove the rubber bushings from the outer trim ring.

Use the Metal Bushing to centre the M6x14 bolt in the hole of larger tab of the outer ring.

Next use the M6 nuts to secure the headlight module and bracket to the outer ring. Install 1 x M6 washer & 1 x M6 Lock Washer on the bolt side (outside) of the bracket.

Connecting the wiring.

Plug the H4 (3 pin) connector to the OEM H4 plug.

Use the Quick Splice connector to the positive wire from the park light (normally a brown wire). Connect the red wire from the HogLight to the Quick Splice connector.

N.B. If you do not have a park light, use the Quick Splice connector to tap the red park wire into a wire on your bikes harness that only gets power once the ignition has been turned on. For example, your motorcycle's running light wire or dash light wire are a switched 12-volt power sources.

Installing the Module – Part 2

Re-use the OEM screws to attach the outer trim ring to the headlight bucket. Please ensure you do NOT over tighten the OEM screws into the headlight bucket.

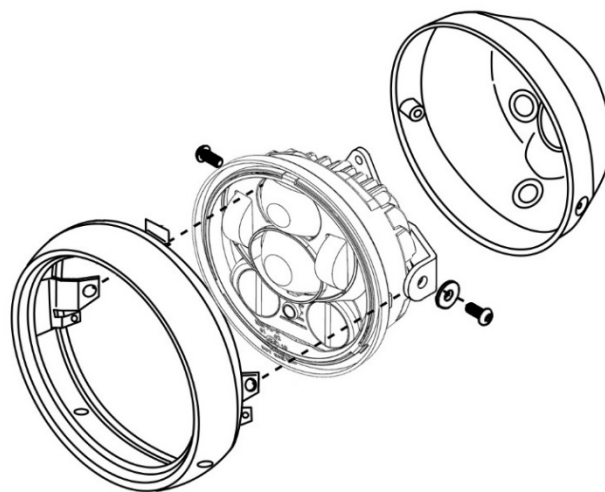
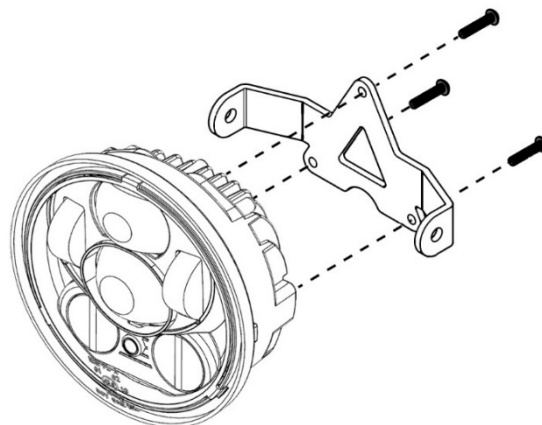

If you have any difficulties, please don't not hesitate to call us on +61 7 3350 3000.

This number is diverted to our tech support team after hours/weekends.



HogLIGHTS

CAN YOU SEE ME NOW
ARSEHOLE!

Condensation in your Lights

Condensation is a naturally occurring condition that can affect any light. It does not suggest a defect in a product, as opposed to what happens when a leak occurs, in which case there is water ingress that could lead to a system failure. The explanation below is intended to help you differentiate between these two conditions so you understand what, if anything, needs to be done.



Condensation

Condensation is the change of water from a gaseous form (vapor) into liquid water. It appears as small droplets of moisture inside the light.

Condensation does not cause a problem with normal operation of the light and is, therefore, NOT considered to be a defect or warrantable condition.

In fact, HogLights lamps are designed to allow moisture to escape and not re-enter, but it takes time for the moisture to evaporate (the amount of time will depend upon whether or not the light is turned on or not).



Water Ingress

Water ingress describes water that leaks into the light, manifesting itself as large droplets or pooling of water that is clearly visible. Sources of water ingress can vary.

If a light suffers water ingress as the result of physical abuse and/or misuse, it would not constitute a manufacturing defect.

Otherwise, water ingress caused by a defect in workmanship is a warrantable item. In this event, please contact us or the dealer who supplied the product to schedule a return.

To assist with your return, please photograph the water, as clearly as possible then email to support@hoglights.com.au

Virtually all lights are prone to condensate due to the following events:

- Air is trapped inside a lamp when manufactured;
- Plastic parts used in lights naturally absorb moisture in the air;
- As the light heats up these plastic parts release moisture that mixes with air;
- Moisture attaches itself to the coolest part of the lamp, e.g. the lens;
- Halogen lamps tend to run hot so the moisture evaporates more quickly;
- LED lights produce less heat so moisture takes longer to evaporate, so it can be more noticeable

We hope you enjoy our products and have many years of great use from them.