

1

Peel adhesive backs and place **filler panel** into position. Keys precisely into position to provide a flat surface for the foundation.

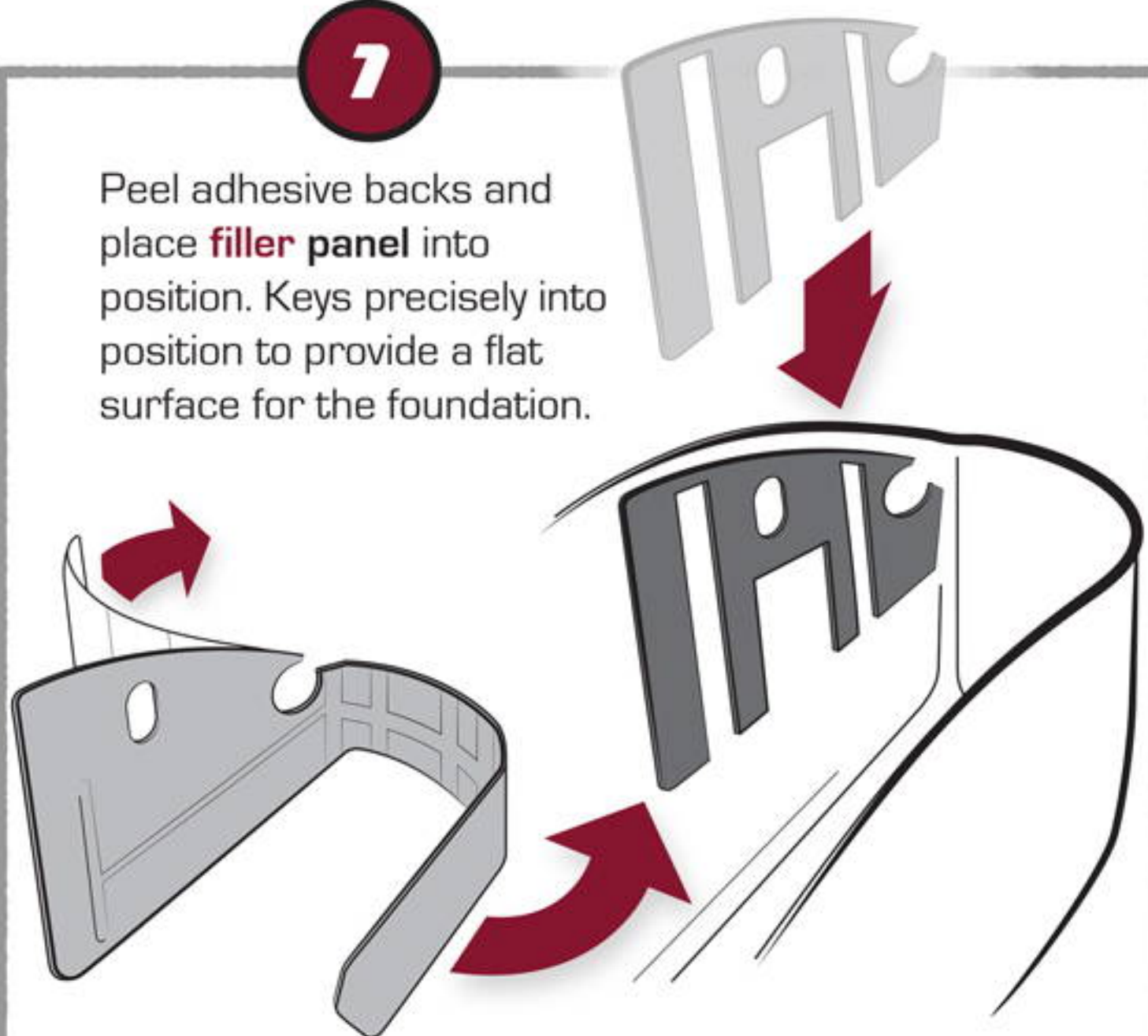

Peel adhesive back and place **foundation** over the top of the **filler panel**, and walk it around the inside of the saddle bag.

2

Place **shelf** into the groove.

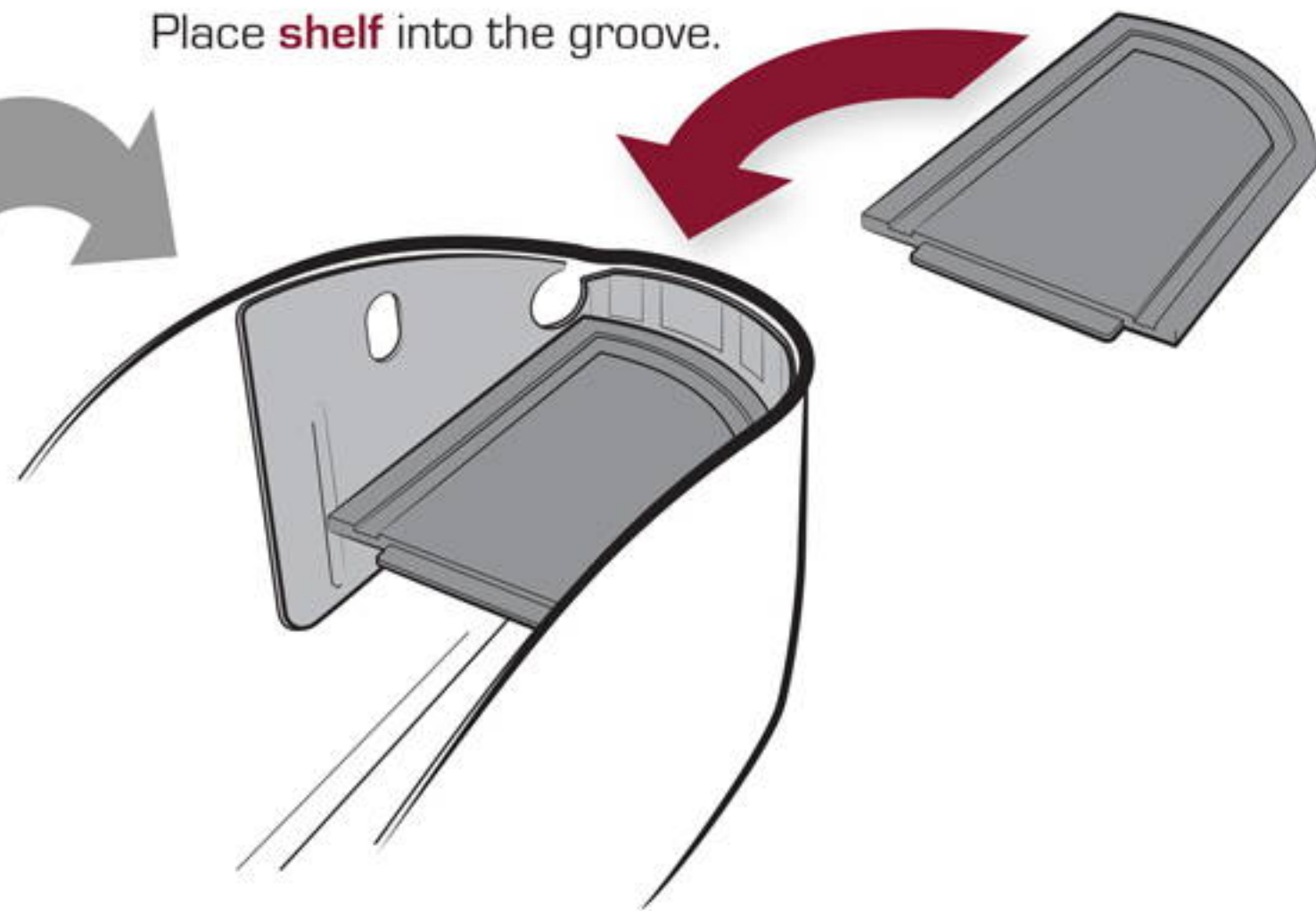

3

Place the **lock wall** from the back until it snaps into position.

