

HOGTUNES

Audio Solutions For The Great American Cruiser



G4 RG KIT-RM

**HIGH PERFORMANCE FRONT SPEAKER KIT
WITH 225 WATT AMPLIFIER**

FOR USE ON 2015+ "RUSHMORE" ROAD GLIDE MODELS

INSTALLATION MANUAL

*A video version of this manual is available at
www.hogtunes.com/support/videos.html
If you still need assistance, please consider a professional
installation by your motorcycle dealer.*

Thank you for choosing the Hochtunes G4 RG KIT-RM kit for 2015+ Rushmore Platform Road Glides. Since positive word of mouth is the best way to grow our business, we want your new system to work as well as it was designed to. If you have any questions or concerns, we are here to help.

The REV 225-RM amplifier is a Class D design. It should be understood that ALL Class D amplifiers, REGARDLESS OF BRAND, cause a reduction in FM reception. The REV 225-RM features a proprietary circuit design called R.E.M.I.T. (Reduced Electro Magnetic Interference Technology) that Hochtunes believes gives the BEST FM reception available for any Class D Amplifier designed for a motorcycle. If you add a 2nd or 3rd model amplifier to your system, reduction of FM reception is increased and is considered normal.

Hochtunes understands that some riders prefer the cosmetics of in-fairing antennas, however it should be noted that NOTHING WORKS AS WELL AS THE FACTORY ANTENNA. If FM is an important part of your riding experience, we strongly advise against the use of any in fairing type antenna!

To help protect your bike's electrical system and battery, the amp has a built in feature where it will turn itself off if it sees less than 10.5 volts, whether the bike is running or not. If you're listening to your stereo while not riding, this feature can help protect your battery so the bike can still start. If you're riding and the amp shuts off, this could be showing a potential issue with your charging system. If this feature is activated and the amp shuts off, it will turn the amp back on again if the voltage exceeds the 10.5 volt threshold.

REV 225-RM is rated for 112.5 watts per channel @ 2 ohms. Although this amplifier makes its highest power with 2 ohm speakers, if Hochtunes 5.75 ohm speakers or 4 ohm car speakers are used there will still be a noticeable improvement in volume and sound quality.

The installation will be done in 3 steps.

STEP 1: CHANGING OUT THE FRONT SPEAKERS

STEP 2: INSTALLATION OF THE AMPLIFIER

STEP 3: ROUTING THE POWER HARNESS

Hochtunes Contact Information

Email: tech@houghtunes.com

Telephone (USA) 608-554-7631 • (Canada) 705-719-6361

462F-RM FRONT SPEAKER INSTALLATION INSTRUCTIONS

- Step #1: Remove the seat and both wires (+ and -) from the battery. Each factory speaker grill will be removed from the inner fairing by prying up on them. In most cases you can pry these off with your fingers, but if you must use a tool, please use something with a 90° end being extra careful not to scratch your inner fairing.
- Step #2: Remove the outer fairing from the bike and then the headlamp assembly. Refer to a service manual if you need help with this. NOTE: Placing a towel on the front fender can help prevent scratches or "dings" from dropped tools or fasteners etc. Expletives will also be kept to a minimum!
- Step #3: Undo the 4 screws that hold the factory speaker to the cabinet. Carefully take off each speaker wire by disconnecting one at a time. Take a Hogtunes speaker and attach the factory speaker wires noting they will only go on one way. You will need to "maneuver" the new speaker into place so it will go past the grill opening but it will go in without force.
In order to make the speaker install properly, the speaker wire tabs must be oriented so they are closest to the top of the inner fairing (12 o'clock position). Reinstall the factory screws to secure the speakers in place making sure the speaker is flush to the mounting plane.
- Step #4: On the back of each stock speaker grill, you will see a rubber gasket and 2 white clips. These gaskets and clips will be removed from the factory grills and re-installed on the Hogtunes grills. Once the gaskets and clips are installed onto the new grills, put the grills aside and move to the next step.

The supplied Hogtunes grills are designed so the metal mesh and grill frame are easily separated for custom finishing. The metal mesh is thick enough so it should not warp during processing such as polishing or powder coating.

REV 225-RM AMPLIFIER INSTALLATION INSTRUCTIONS

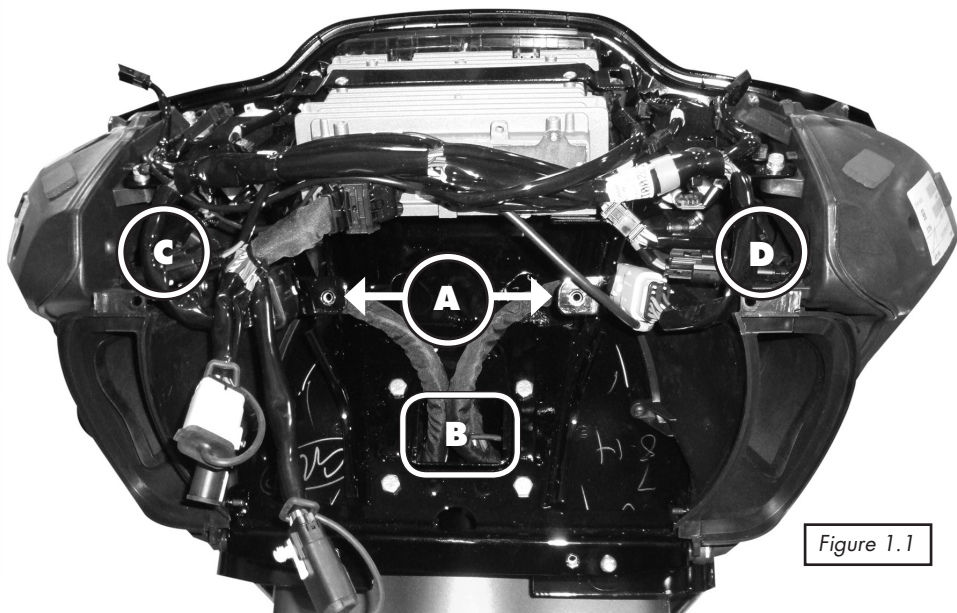

Figure 1.1

Before proceeding, please locate the points in the fairing identified by the letters in Figure 1.1.

A= mounting points for Headlight assembly

B= Wire passage from fairing to bike

C= Brake side speaker harness (Pink and Pink with Black Stripe wires)

D= Clutch Side Speaker harness (Pink and Pink with Black Stripe wires)

Step #1: Out of the box, the amplifier comes on a mounting plate used for Street Glide and Ultra fairings only. Separate the amp from the plate and put that plate aside. As shown in Fig 1.2, locate the Road Glide specific plate and attach the amp to the plate so it is in the same orientation as shown. When installed, the amp will be on the back of the plate. We do this so it is much easier to put a second amp later if you choose. The second amp sticks to the front of the plate.

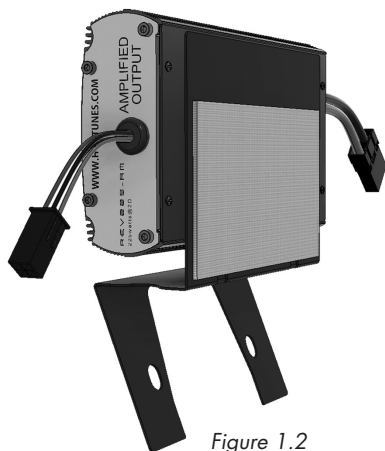

Figure 1.2

Step #2: Locate the power harness for the amplifier. One end has ring terminals and a fuse and the other has a 2 pin connector. Using Fig 1.1 on Page 3 for reference, you want to run the "ring terminal end" of the power harness through "B". Position it so the 2 pin power connector is accessible in the inner fairing and the slack can be adjusted later in the installation. Just in front of the tank, there is a structure that attaches the fairing to the frame of the bike. The power harness will pass through this structure and exit through the rectangular opening where the factory harness also exits the structure on the BRAKE side of the bike. Note: it can be easier to pass the wire harness through the rectangular opening if you open the fuse holder and remove the fuse before passing the wire harness. You can run the power harness under the gas tank if you are comfortable removing the gas tank, or you can run the power harness up and over the tank but under the chrome console.

With the power and ground wires in the vicinity of the battery, move to step #3 WITHOUT connecting amp wires to battery.

Step #3: Locate the "audio in" harness and plug its 8 pin white plug into "audio in" on the side of the amp. Locate the amp's "front out" harness and plug it into the 4 pin BLACK pigtail coming out of the side of the amp.

Note: There is a 3 position switch on the side of the amplifier. For all typical installs, this should be in the "+3" position. The switch allows you to tune the amp in relation to other speakers and/or amps on the bikes if they are added.

Step #4: Using Fig 1.1 on page 3 for reference, locate the 4 bolts around "B" and remove the top left and top right bolts (only). Also using Fig 1.1 on page 6 for reference, you will see 2 large factory harnesses between "A" and "B". You will have to wiggle the amp on the plate into place around these harnesses so that the holes on the "legs" at the bottom of the plate line up with the holes where the factory bolts around "B" were. With the plate in position, reinstall the factory bolts around "B" which will secure the amp on its plate to the bike.

- Step #5: As shown by "C" in Figure 1.1, on the brake side of the bike, there is a 2 pin connector with pink/pink with black stripe wires going through it. The plug is close to where the wires enter the brake side speaker cabinet. Separate the connector so there are 2 plugs. From the amp, take the plug with blue/black wires and plug it into the mating plug you just separated noting it will only go in one way. Also from the amp, take the plug with green/black wires and plug it into the mating plug you just separated noting it will only go in one way.
- Step #6: As shown by "D" in Figure 1.1, on the clutch side of the bike, there is a 2 pin connector with pink/pink with black stripe wires going through it. The plug is close to where the wires enter the clutch side speaker cabinet. Separate the connector so you now have 2 plugs. From the amp, take the plug with brown/black wires and plug it into the mating plug that was just separated noting it will only go in one way. Also from the amp, take the plug with yellow/black wires and plug it into the mating plug that was just separated noting it will only go in one way.
- Step #7: Attach the black wire to the negative (-) battery terminal and the red wire to the positive (+) battery terminal. The factory battery wires are also re-installed at this point. When attaching the power and ground wires, it is always a good practice to do the negative (black) first. When the positive connector touches the battery, some sparking is normal. This is a function of the capacitors in the amplifiers charging up.

Turn the stereo on and, at low volume, test to make sure the speakers are working. Now is a good time to "clean up" and secure the wires using the supplied zip ties. For best possible FM reception, DO NOT attach any of the amplifier's wiring to any factory antenna wires. Doing so will hurt your radios ability to receive FM signals!

IMPORTANT: With all wires secured, turn the front wheel to each extreme side making sure that any wires cannot bind or impede the steering of the motorcycle. Failure to do so can cause an accident resulting in serious injury or death!

With everything installed, re in-install the outer fairing, and install the new fairing speaker grills.

PLEASE GO TO "FINAL SYSTEM ADJUSTMENTS" NEAR THE BACK OF THIS MANUAL

EASY SYSTEM UPGRADE 1

Adding a second amp is easy and will give you the incredible power of 2 x REV 225-RM. The first amp will power the front speakers as it does now, while the second amp can power speakers in Hogtunes saddlebag lids, lower fairings, or rear speaker pods on Tour Paks.

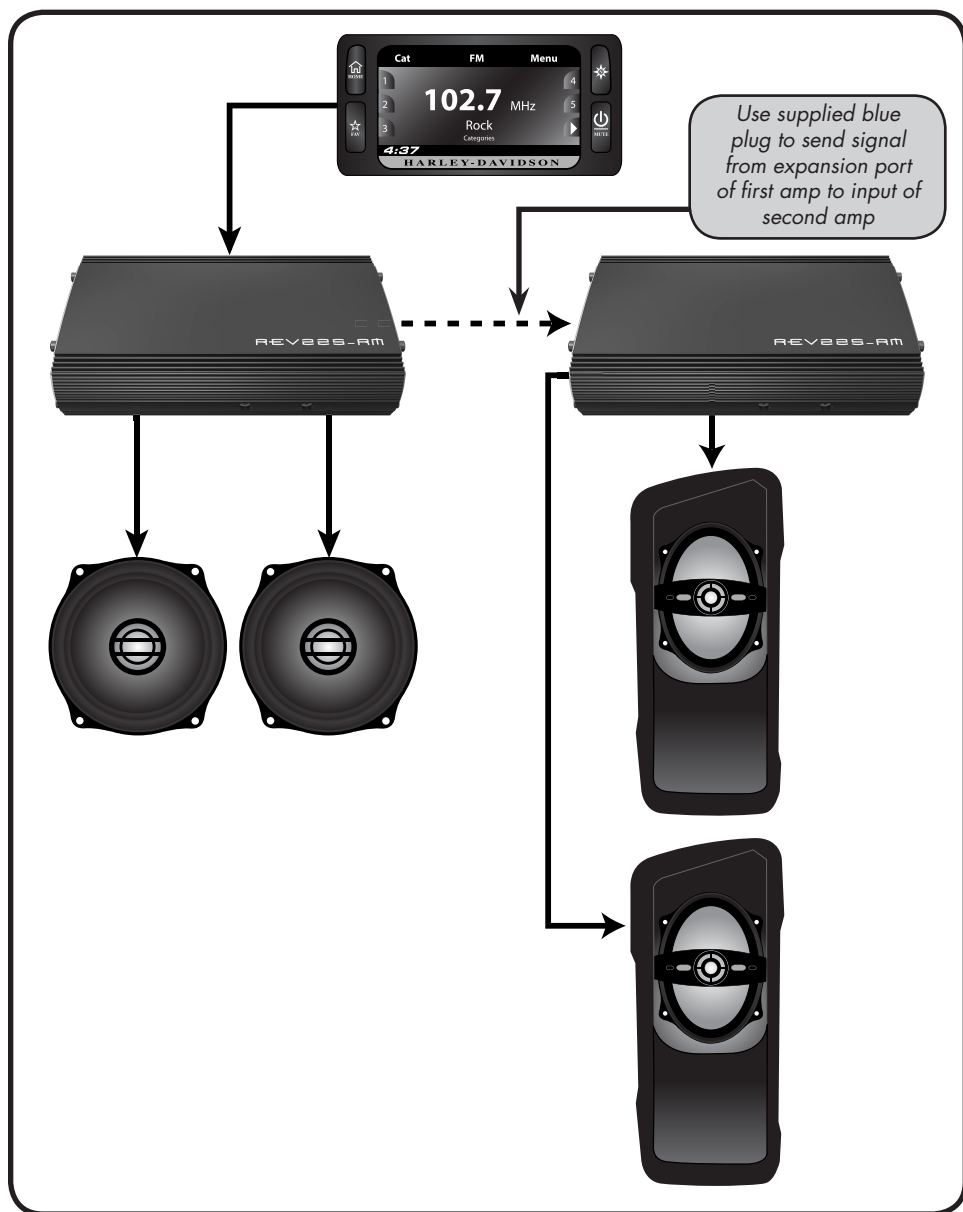

EASY SYSTEM UPGRADE 2

Adding a second and third amp is easy and will give the CRAZY power of 3 x REV 225-RM. The first amp would power the fairing speakers, while the second and third amps would power speakers in Hogtunes saddlebag lids, lower fairings, or rear speaker "pods" on Tour Paks. Note: The 3rd amp mounts to the brake side speaker cabinet and requires Hogtunes FLTR Side Plate-RM for mounting (Drag Specialties Part #4405-0531)

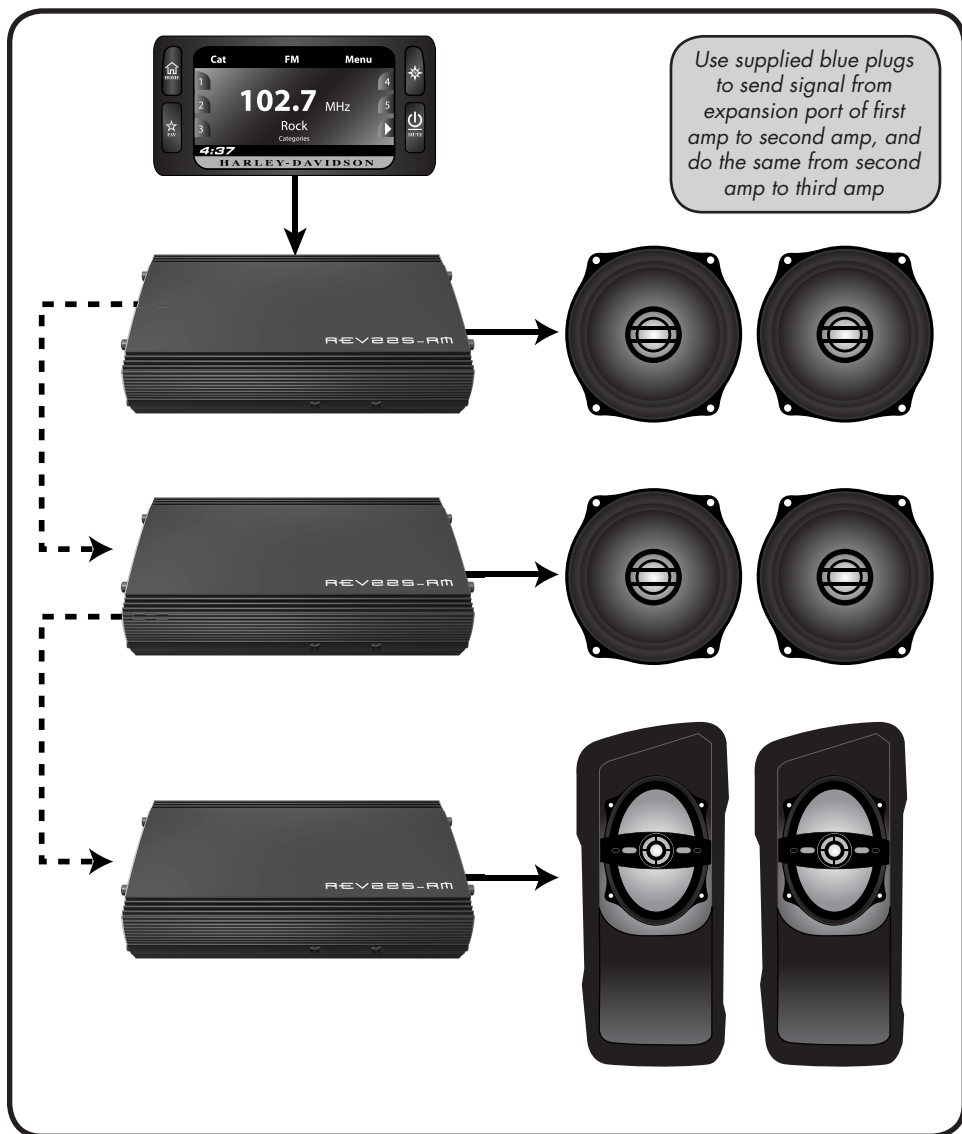

FINAL SYSTEM ADJUSTMENTS

From time to time, the “Motor Company” will release software updates on their website which can be downloaded, and installed on your bike. For best performance of the audio system, please make the downloads are up to date! Earlier versions of the software could cause any brand of aftermarket amplifier to distort prematurely so this is an important point!

How the system sounds when the bike is running is going to differ from how it sounds when the bike is not running. This is a function of the radios built in software. You may find yourself adjusting the bass and or treble controls if you’re listening to the bike without the motor running.

A Couple Of Tips To Have Your System Sound Great

- 1) Many people will store music on a hand held type player and use that as the music source for the bike’s audio. PLEASE NOTE: If you “borrow” your music files from certain sites, they typically sound poor. Using a good quality file will only make your system sound better!
- 2) Many people will take advantage of the convenience of ‘streaming” their music to the radio using Bluetooth®. It should be noted that we found plugging in your music device using the radios USB cord sounds better and plays louder than using Bluetooth.
- 3) Streaming your music in from internet based radio is not always consistent, especially outside of populated areas. When streaming while riding, the quality of the audio is greatly effected by the speed of the cell signal you’re in at any given time.

WARRANTY INFORMATION

IMPORTANT: In the event of a warranty claim, please fill out the form in the Warranty section of our website, or contact us by email or by phone. Valid claims will have an Return Authorization Number (RA#) generated which **MUST** appear on the outside of the box when it arrives to our office.

Goods Arriving Without an RA# Will Be Refused!

Please Record Your Amplifier's Serial # Here _____

Hogtunes speakers are warranted for a period of 20 years. The REV 225-RM Amplifier is warranted for 3 years from original purchase date. Proof of purchase is required for all warranty claims. The warranty applies to the original retail customer and is not transferable. Please contact Hogtunes for all warranty claims. Products found to be defective during the warranty period will be repaired or replaced (with a product deemed to be equivalent) at Hogtunes sole discretion. Hogtunes complete warranty policy is available on our website at:

www.hogtunes.com/warranty.html

What Is Not Covered:

- 1) Any expense related to the removal or re-installation of Hogtunes products.
- 2) Repairs to these products performed by anyone other than Hogtunes.
- 3) Subsequent damage to any other components.
- 4) Any product purchased from a non-authorized Hogtunes dealer.
- 5) Damage to Hogtunes products due to an accident or collision.
- 6) Hogtunes Amplifiers with broken or removed "warranty void" stickers.
- 7) Damage due to water from custom installations.
- 8) Damage from incorrect installation, improper use, abuse or modifications.
- 9) Damage to inbound product due to improper packing.

Hogtunes Inc. is owned by Powersports Audio Inc.

Powersports
...AUDIO INC.

Harley-Davidson, Electra Glide, Road Glide, Street Glide, Ultra Classic, Tri Glide, CVO, Screamin Eagle and Tour-Pak® are Trademarks, and/or Registered Trademarks of Harley-Davidson, Inc., Milwaukee, Wisconsin, USA, and if Used or Implied are for Reference Only. There is No Affiliation Between Harley-Davidson, Inc., and Hogtunes Inc.

**PRACTICE
SAFE
SOUND!**

Hogtunes products will play much louder than the Original Equipment, which can be a distraction to the rider and/or passenger. Please use caution when adjusting or playing your stereo at high volume, especially in traffic.

You are a valued customer so please:

**Ride Alert
Arrive Alive!**

www.hogtunes.com