

INSTRUCTION SHEET FOR PRO-CUT SUPER KIT No. 2386-7P

FOR USE IN STOCK 5-SPEED BIG TWIN CASES 1990-PRESENT



NOTE: If you are starting out with a bare case to install your Jims Super Kit into, you should be aware that you must use all corresponding part numbers for the year of application. This is important with the shifter mechanism, shift drum, drum supports, top lid, neutral switch and centering adjuster screw, for all to function correctly.

Application/ Year	Part No.	Gear Ratio
1990-Present BigTwins	2386-7P	Close-Ratio

JIMS® Recommended Tool List	
No. 2316 or 2317	Primary Locking Bar
No. 38515-90	Clutch Spring Compressor Tool
No. 34902-84	Mainshaft Bearin Race Tool
No. 94660-37A	Mainshaft Sprocket Lockout Wrench
No. 2260	Big Twin Sprocket Lock Tool
No. 95660-85	Main Seal Driver Tool
No. 1720	5-Speed Main Bearing Remover Tool
No. 35316-80	5-Speed Transmission Main Drive Gear Tool
No. 1134	Retaining Ring Pliers Kit
No. 2283	5-Speed Door Puller Tool

1. Refer to H-D® service manual for your year and model motorcycle for installing your JIMS® Super Kit. This installation is performed the same way as a stock factory trap door and gear set are installed.
2. After disassembly of existing trap door and gear set from the transmission case, clean and inspect for any defects in the case. Then install new seals, bearings and retainers provided. See parts list and exploded view of Super Kit, on pages 2 & 3. See recommended tool list above.
3. Install the shift lever assembly inside case, then centering adjusting screw, and lock mount.
4. Install 5th gear mainshaft using JIMS® Tool No.35316-80. This will install the fifth gear (mainshaft) properly into the Main Bearing No.8996.
5. You are now ready to install the Trap Door Gasket, Gears and Shaft Assembly into the case. Refer to your factory Harley-Davidson® manual for torque specs when assembling.
6. Refer to manual for installing inner primary. After you have your inner primary cover mounted in place, then you need to install JIMS® No.34091-85 bearing inner race onto mainshaft. Refer to Harley-Davidson® manual for proper location and use JIMS® Tool No.34902-84 for performing this properly.
7. You are now ready to install your pulley, clutch assembly and primary chain, primary cover, etc. See H-D® factory manual for assembly.
8. After all is assembled, add JIMS® No.1230, 80W90 Gear Oil or equivalent. We recommend 500 miles on first service interval, then factory suggested intervals there after.

WARRANTY

All JIMS® parts are guaranteed to the original purchaser to be free of manufacturing defects in material and workmanship for a period of six (6) months from the date of purchase. Merchandise that fails to conform to these conditions will be repaired or replaced at JIMS® option if the parts are returned to us by the purchaser within the six (6) months warranty period or within ten (10) days thereafter.

In the event warranty service is required, the original purchaser must call or write JIMS® immediately with the problem. Some problems can be rectified by a telephone call and need no further course of action. A part suspected of being defective must not be replaced by a dealer without prior authorization by JIMS®. If it is deemed necessary for JIMS® to make an evaluation to determine whether the part is defective, it must be packaged properly to prevent further damage and be returned prepaid to JIMS® with a copy of the original invoice of purchase and a detailed letter outlining the nature of the problem, how the part was used and the circumstances at the time of failure. If after an evaluation has been made by JIMS® and the part was found to be defective, repair, replacement or credit will be granted.

ADDITIONAL WARRANTY PROVISIONS

1. JIMS® shall have no obligation in the event a JIMS® part is modified by person or organization.
2. JIMS® shall have no obligation if a JIMS® part becomes defective in whole or in part as a result of improper installation, improper maintenance, improper use, abnormal operation, or any other misuse or mistreatment of the part.
3. JIMS® shall not be liable for any consequential or incidental damages resulting in the failure of a JIMS® part, the breach of any warranties, the failure to deliver, delay in delivery, delivery in non-conforming condition, or for any other breach of contract or duty between JIMS® and a customer.
4. JIMS® parts are designed exclusively for use in Harley-Davidson® motorcycles. JIMS® shall have no warranty or liability obligation if JIMS® part is used in any other application.
5. Any JIMS® parts or tools that are returned and replaced become the property of JIMS® and will not be returned under any circumstance.

CAUTION: WEAR SAFETY GLASSES. EXCESSIVE FORCE MAY DAMAGE PARTS!
SEE JIMS® CATALOG FOR HUNDREDS OF TOP QUALITY PROFESSIONAL TOOLS.
THE LAST TOOLS YOU WILL EVER NEED TO BUY.

Performance Parts For Harley-Davidson® Motorcycles

EXPLODED PARTS VIEW

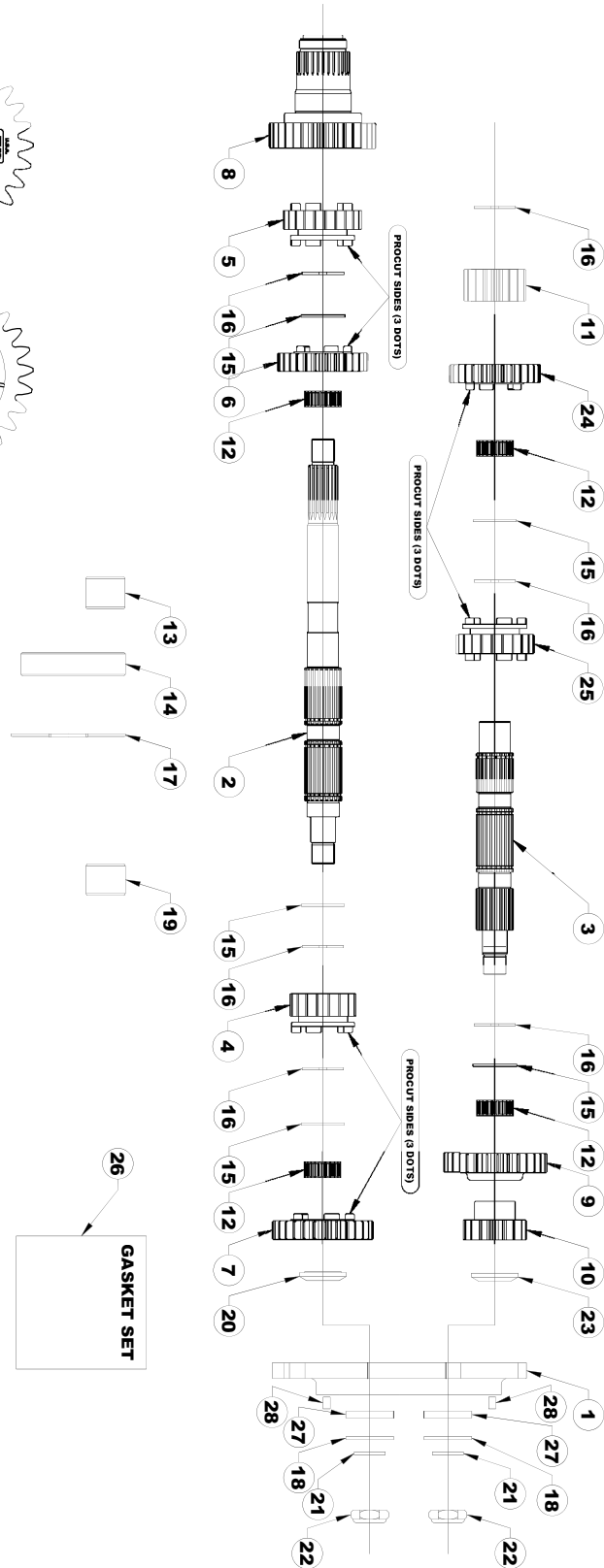

- NOTE:**
1. Pro-Cut gears are designed and manufactured different than Clean-Cut gears.
 2. Clean-Cut gears are not designed to work with Pro-Cut gears. Do not mix gears.
 3. Each Pro-Cut gear is identified by 3 "PIP" marks

CAUTION: WEAR SAFETY GLASSES. EXCESSIVE FORCE MAY DAMAGE PARTS!
SEE JIMS® CATALOG FOR HUNDREDS OF TOP QUALITY PROFESSIONAL TOOLS.
THE LAST TOOLS YOU WILL EVER NEED TO BUY.

Performance Parts For Harley-Davidson® Motorcycles



INSTRUCTION SHEET FOR PRO-CUT SUPER KIT No. 2386-7P

5-SPEED PRO-CUT SUPER KIT CLOSE RATIO PARTS LIST

PARTS LIST			
NO.	QTY.	TITLE OR DESCRIPTION	PART NUMBER
1	1	TRAP DOOR, T/C, POLISHED	2326
2	1	MAINSHAFT	35042-91
3	1	COUNTERSHAFT	35632
4	1	GEAR, CLOSE RATIO, MAINSHAFT 1st	8058A
5	1	GEAR, MAINSHAFT 2nd PROCUT	8058C
6	1	GEAR, MAINSHAFT 3rd PROCUT	8058E
7	1	GEAR, MAINSHAFT 4th PROCUT	8058G
8	1	GEAR, MAINSHAFT 5th	8296
9	1	GEAR, CLOSE RATIO, COUNTERSHAFT 1st	35622-CR
10	1	GEAR, COUNTERSHAFT 4th	35625-79B
11	1	GEAR, COUNTERSHAFT 5th	8299
12	4	BEARING, MAINSHAFT & COUNTERSHAFT	8876A
13	1	BEARING, COUNTERSHAFT END	8977
14	1	BEARING, TRANSMISSION CASE	8996
15	5	THRUST WASHER, MAINSHAFT & COUNTERSHAFT	6003
16	6	RETAINING RING, MAINSHAFT & COUNTERSHAFT	11067
17	1	RETAINING RING, MAIN DRIVE GEAR	11161
18	2	RETAINER, TRAPDOOR BEARING	35087-99
19	1	RACE, MAINSHAFT INNER PRIMARY	34091-85
20	1	SPACER, MAINSHAFT DOOR SIDE WITH SHOULDER	35064-79
21	2	SPACER, WASHER, MAINSHAFT & COUNTERSHAFT	35076-79
22	2	LOCK NUT, MAINSHAFT & COUNTERSHAFT	35078-79
23	1	SPACER, COUNTERSHAFT	35629-79
24	1	GEAR, COUNTERSHAFT, 2nd, PROCUT	8058B
25	1	GEAR, COUNTERSHAFT, 3rd, PROCUT (1 SIDE)	8058F
26	1	GASKET SET	803
27	2	BEARING, TRAPDOOR	8992
28	2	ROLL PIN, TRAPDOOR	609

CAUTION: WEAR SAFETY GLASSES. EXCESSIVE FORCE MAY DAMAGE PARTS!
SEE JIMS® CATALOG FOR HUNDREDS OF TOP QUALITY PROFESSIONAL TOOLS.
THE LAST TOOLS YOU WILL EVER NEED TO BUY.