



FLARE™ WINDSHIELD FOR FLH HARLEY DAVIDSON



EMAIL:
info@getklocked.com



CALL:
(605) 996-3700



1. Remove the three windshield mounting bolts on the top of the fairing, and remove your stock windshield

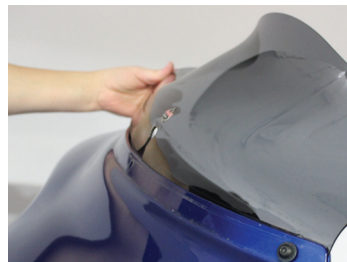

4. Guide the opposite end of the Flare™ down onto the other outer mounting boss



NOTE: Gently pushing the windshield forward from behind the center screw may aid in removal.

2. Install the outer two mounting bolts loosely



5. Gently guide the center of your Klock Werks Flare™ over the center mounting boss and start the center mounting screw by hand



3. Guide an end of your new Klock Werks Flare™ down onto one of the outer mounting bosses



7. Secure the windshield mounting hardware, making sure that the Flare™ is resting on the mounting bosses and not on the mounting screw to avoid pinching



* A misaligned or incorrectly installed windshield, can cause damage around the mounting hole.

Klock Werks cannot be held responsible for any damage resulting from improper installation performed by any consumer or their dealer.

MORE WAYS TO KLOCK YOURSELF OUT

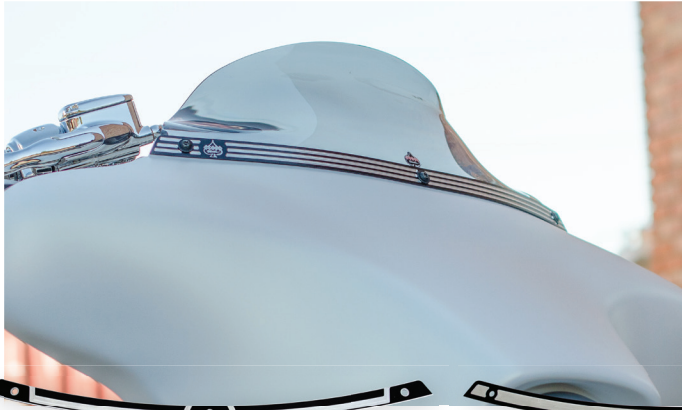

FLW

FLARE™ SERIES WINDSHIELD TRIM

- // The final touch for your Flare™ Windshield
- // A detail that sets your bike apart
- // Five different designs to choose from
- // Available in Black Contrast and Chrome
- // Easy to install!

RELIEF



KW LOGO (KERF)



AZTEC



LANDING



FAIRING VENT SCREENS FOR 2014+ FLH

- // Stop bugs and road debris!
- // Accent your vent and add a kustom touch
- // Available in Honeycomb or Round pattern mesh aluminum



KLOCK WERKS CLEANING PRODUCTS

- // The recommended cleaner for your Flare™ Windshield
- // Proprietary concoction designed by REAL riders
- // Protects surfaces while repelling dirt
- // Complete line for all finishes

U.S. Pat. No. D586,274; D632,235; D586,275; D633,017; D626,046; D633,018 Pat. 001050165-0001, 001050165-0002, 001050165-0003 APO No. 324093, 324094, 325192

KLOCK WERKS // GETKLOCKED.COM