

INSTRUCTION SHEET



FLARE™ LOW RIDER ST

INCLUDED COMPONENTS:

- Flare™ Windshield
- Installation Instructions

TOOLS NEEDED:

- T25 Torx Driver

QUESTIONS?



EMAIL:
info@getklocked.com
CALL: (605) 996.3700



1. Using a T25 Torx driver, loosen the four outermost windshield screws.
2. Remove the two center windshield screws, the rubber grommets will remain in the windshield.
3. Pull the windshield up allowing the slots in the windshield to slide off of the four remaining grommets on the outermost screws.

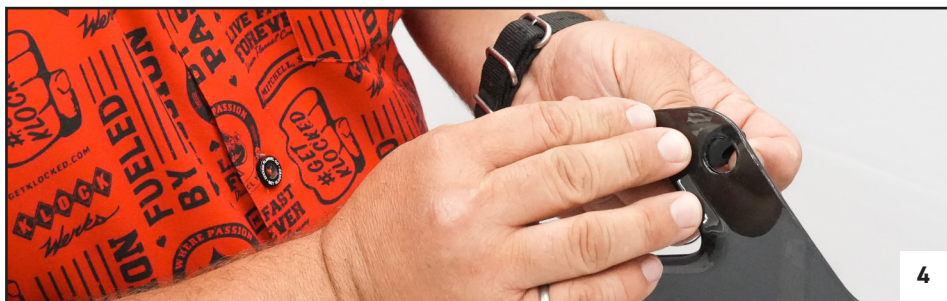

4. Remove the two rubber grommets from the center holes in the windshield by gently rolling the front through the shield to the rear. It is important to note that the grommets need to be removed to the rear as there is a steel reinforcement on the back that could cause damage if removed incorrectly.
5. Remove the remaining four screws and grommets from the fairing.

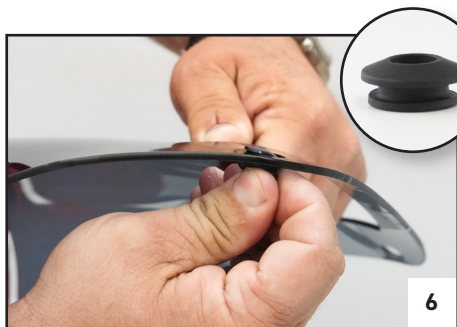

6. Install the six windshield grommets into your new Klock Werks Flare™ from the rear noting the tapered end of the grommet goes forward. A small amount of Shine Werks around the hole and on the grommet will make this step easier.
7. Place your Flare™ on the fairing in place and reinstall the screws to the factory recommended torque specification.
8. Using your Shine Werks, give the windshield and fairing a good wipe down and enjoy the ride.

NOTE: Should you find yourself needing replacement grommets, the Harley part # is: 12100206

FLAREST01R1 © 2022 KLOCK WERKS

Klock Werks is not responsible for any damage resulting from improper installation performed by any consumer or their dealer.