



# Installation Manual

## Lowering Kit Type MP1

For Harley-Davidson® Milwaukee-Eight Softail® Models ab 2018 and up

**Artikelnummer: 130-30**

### Fits following models:

· F(L)XBR(S)	Breakout®	Sport Glide®
	Deluxe®	Heritage Classic®
	114 Softail®	
	Fat Boy®	Low Rider S®

The lowering system from Müller Motorcycle AG complied the legal requirements of the KBA in every position of the lowering!

Änderungsstand 02, 22.03.2021

**Conversion kit MP1 – Art.-Nr. 130-30/1304-065** includes a lowering eye with bearing, thread adapter and a spring washer.

### Special tools needed for mounting:

Spring compressor  
(we recommend the Müller spring compression tool, Part. -Nr.: 130-0)

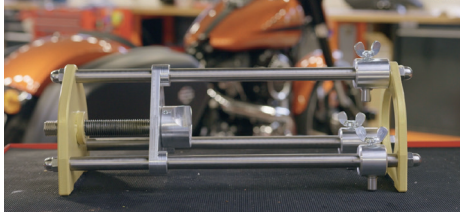

**Caution:** The installation should be carried out by qualified persons!

### Installation Manual:

**1.** Make sure your bike has a safe stand by using a hydraulic ramp and an appropriate motorcycle jack.

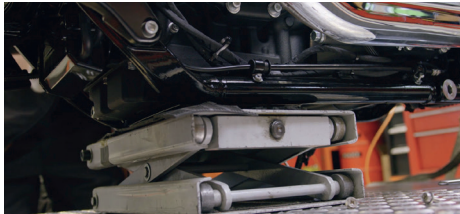

**2.** Relieve the damper and turn the hand wheel to position 0. Demount your strut assembly from your bike. Undo all necessary screws, bolts and clamps according to original workshop manual.

**3.** Fasten your strut in the Compression tool and make sure it is properly fitted in the tool.

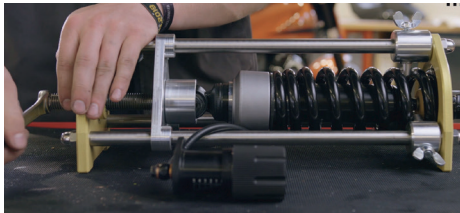

**4.** Preload the damper as far as you reach the hexagon nut of the strut eye.

**5.** Heat up the strut eye with a heat gun and loosen the counter nut.

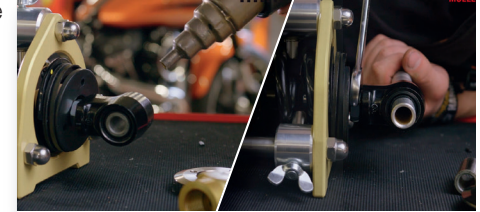

**6.** Remove all original parts.

*These components will be not used anymore. You can but keep these if Your damper someday want to retool again.*



## !!! Attention, now we get to the actual height adjustment !!!!

7. The height of the bike will be adjusted with the spring washer (Pos. 3). For a maximum lowering of 40mm you must rotate the spring washer (Pos. 3) onto the damper rod all the way to the stop.



**Note:** If you don't want it all the way lowered by 40mm, following rule applies: With every complete turn of the spring washer (Pos. 3) backwards, the tail comes up by 3mm. That is how you achieve your personal desired level of lowering.

8. Now screw on the thread adapter (Pos. 4) with the two drillings facing towards the spring washer (Pos. 3) onto the damper rod and counter secure it with the spring washer (Pos. 3). Max. torque for tightening is 25 Nm!

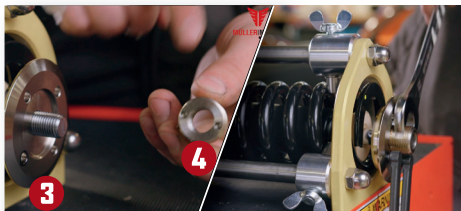

9. Take the new lowering eye (Pos. 2) and screw it all the way onto the thread adapter (Pos. 4) and counter secure the lowering eye (Pos. 2) with the spring washer (Pos. 3). Max. torque for tightening is 25 Nm!



10. For easier assembly of the strut you have to align the drillings with the drillings of the lowering eye.

11. Now you can take out the strut of the compression tool and fix it into your bike. Fasten it with all requires screws (max. torque for tightening from original workshop manual).

**!! Caution:** we recommend checking the height of your chassis before reassembling all bolts and clamps. If you don't like the actual height, remove the strut again and adjust the desired height with the spring washer. If the height is ok you may tighten up everything as needed. Finally, the headlight must be realigned.

**The Müller Motorcycle AG crew wishes you lots of fun with your new lowering kit and always a pleasant ride!**



An assembly video can be found at

<https://ideos.m-motorcycle.de/en/einbauanleitungen/130-30>

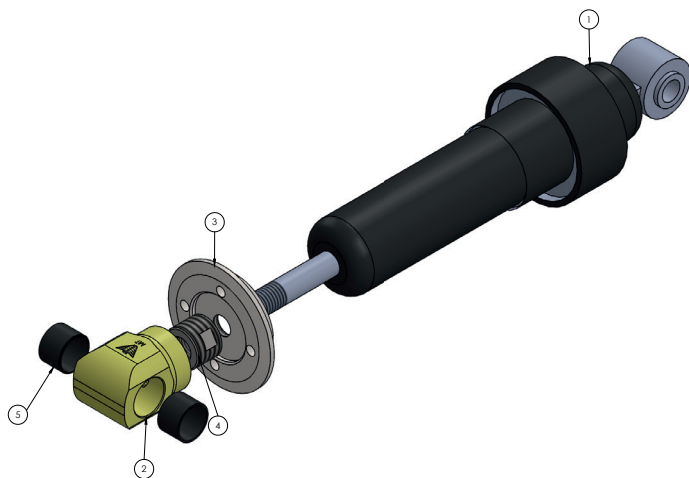

POS	ARTIKELNUMMER / ITEM NUMBER	BESCHREIBUNG / DESCRIPTION	MENGE / QUANTITY
1		FXBR org. Dämpfer / FXBR org. strut	1
2	A01736	Tieferlegerauge / lowering eye	1
3	A01737	Federscheibe / spring washer	1
4	A01738	Gewindeadapter/ thread adapter	1
5	D0204	Gleitlager / bearing	2



**STOP  
TRAINING**



**MÜLLER MOTORCYCLE AG**

Up to  
**45%**  
less pull  
on the clutch lever

**POWER CLUTCH**  
the easy clutch device  
for bowdencable clutches

**HYDRO CLUTCH**  
the easy clutch device  
for hydraulic clutches



**GO RIDING**

[www.m-motorcycle.de](http://www.m-motorcycle.de)

