



### NOSTALGIA TRANSMISSION COVERS



#### PRODUCT DESCRIPTION

2007-LATER TWIN CAM MODELS (6SPD) including 06 DYNA MODELS

0203-2001

1987-2006 BIG TWIN MODELS (5SPD) except 06 DYNA MODELS

0203-2003

1. Turn off motorcycle, disconnect the battery, and place securely on a lift or sidestand.
2. **5spd models:** Some Softail models require removal of the oil tank and frame backbone to allow installation as well as the removal of the front starter bolt. Consult the HD service manual for specific instructions. Once accessible disconnect the neutral switch and remove the factory transmission cover.
- 6spd models:** Simply remove the factory cover.

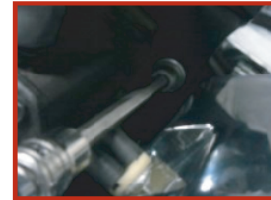

3. Once the existing transmission cover is removed, clean all gasket/mounting surfaces and wipe out all excess oil.
4. **5spd models:** Remove the transmission vent fitting/tube and the transmission neutral switch. These components will be reused.
- 6spd models:** Remove the transmission vent fitting/tube. This will be reused.



5. Install the transmission vent fitting/tube into the RSD transmission cover using teflon tape or liquid thread sealant. Clock the vent fitting to match the factory position.  
**Note:** 2007 6spd models use a threaded vent fitting and 08-up 6spd models use a push-in rubber vent tube.
6. **5spd models only:** Install the neutral switch into the RSD transmission cover.
7. Install the RSD transmission cover onto the transmission using the supplied gasket. Install bolts and torque to 105 in-lbs.

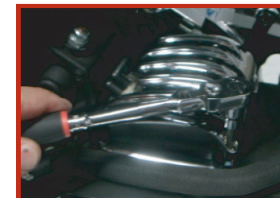

8. Reinstall any components that were removed for access and go for a ride.

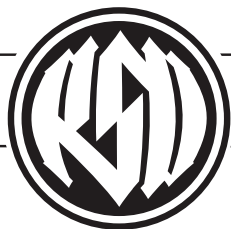

# ROLAND SANDS DESIGN

## CLARITY TRANSMISSION COVER

# ASSEMBLY INSTRUCTIONS

0048-0914

REVISION A

11/8/12

PAGE 2

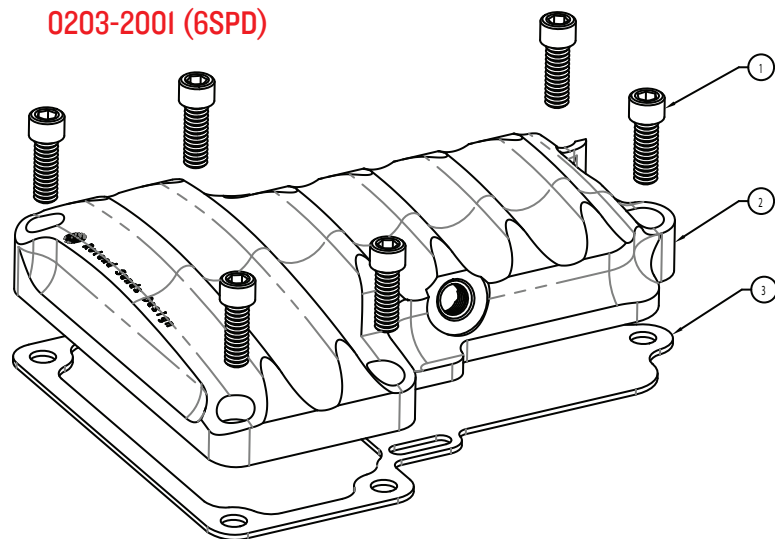
**0203-2001 (6SPD)**

ITEM NO.	PART NUMBER	DESCRIPTION	QTY.
1	0101-1008-CH	SHCS 1/4-20 X 3/4 CHROME	6
2	0203-0008	NOSTALGIA 6 SPEED TRANS COVER, 07-09 ST, 07/09 FL, 06-09 DYNA	1
3	0203-0009	GASKET 6 SPEED TRANS COVER, 07-09 ST, 07/09 FL, 06-09 DYNA	1

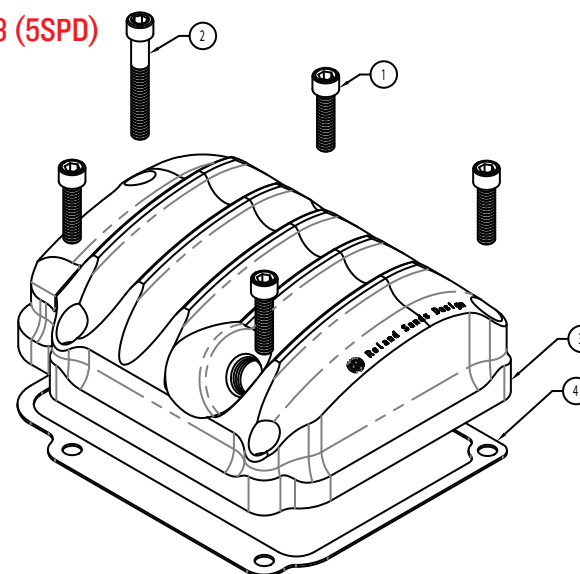
**0203-2003 (5SPD)**

ITEM NO.	PART NUMBER	DESCRIPTION	QTY
1	0101-1012-CH	SHCS 1/4-20 X 1 CHROME	4
2	0101-1022-CH	SHCS 1/4-20 X 1-3/4, CHROME	1
3	0203-0011	RSD 5 SPEED TRANS COVER, 00-06 FXST/FLST, 01-06 FLHT/FLHR/FLTR	1
4	0203-0013	GASKET, RSD 5 SPEED TRANS COVER	1