



Slimline Duals Installation Instructions
Harley-Davidson Touring Models 2009-current

Thank you for buying a Rinehart Racing® exhaust system. We are committed to providing premium products that with proper installation and care will last for many years to come. Please be sure to read the instructions fully and inspect all components of your new system before installation. If you need help removing your stock mufflers and/or head pipes, or how to install the Rinehart Racing exhaust system you should seek the advice and/or skill of a professional mechanic. Please keep all OEM parts as some may be used for the installation of the Rinehart Racing® exhaust system. If you are installing the system and are not the owner, please return these instructions to the owner as they contain important information that may be required at a later date. If you have questions pertaining to the installation, please contact our technical service department: 1.877.264.8282 or www.rinehart racing.com

Discoloration & Tuning:

Discoloration of exhaust is generally a result of fuel calibration tuning. In addition, discoloration can be the result of electrical issues or engine malfunction. Discoloration is not a warrantable item.

Emissions Notice:

The State of California does not permit the use of aftermarket exhaust systems that remove original equipment catalysts unless a California Air Resources Board (CARB) Executive Order has been issued. Exhaust systems that remove original equipment catalysts are legal in California for racing use only. Replacing a catalyst equipped exhaust system with a non-catalyst exhaust system on a registered vehicle in the State of California is illegal and may subject the parties involved (including but not limited to the owner, driver, consumer, mechanic and dealership) to fines and penalties and such action is strictly prohibited by Rinehart Racing™.

Return & Refund Policy:

No return of merchandise will be accepted without first securing a Return Merchandise Authorization ("RMA") number provided by Rinehart Racing. Buyer must submit, in writing, evidence of purchase date, copy of invoice indicating goods purchased, reason for return, exchange or refund, and RMA number. At its sole discretion, Rinehart Racing may accept or deny the claim for return, exchange or damage. If accepted and if the goods have not been used and are in a resalable condition, Company shall provide refund within 30 days of purchase; subject to a fifteen percent (15%) restocking fee. If the product has been installed, no refund, return or exchange shall be allowed. No refund, return or exchange is allowed after 45 days from the date of invoice. Buyer is responsible for return freight, and must include all original packaging, materials, manuals, hardware and copy of invoice. All products returned must be securely packed and delivered to Company in an undamaged condition. Rinehart Racing may refuse or reject returned product for failure to follow the conditions set forth herein.

Limited Warranty:

This Limited Warranty contains the sole express warranty made by Rinehart Racing® ("Company") in connection with exhaust products sold by Company ("Product"). BY PURCHASING OR ACCEPTING THE PRODUCT, THE BUYER ACKNOWLEDGES THAT THE LIMITATION OF LIABILITY IS PART OF THE TERMS OF SALE,

CONSTITUTES A BINDING AGREEMENT, AND MAY BE ENFORCED AGAINST THE BUYER BY COMPANY. Any warranties, if separately provided in writing, are extended only to the Buyer whose name is shown on Company's invoice.

Rinehart Racing® exhaust products are warranted against defects in material or workmanship for a period of 18 months from the date of the original invoice. This does not cover finishes such as plating or painted surfaces with discoloration or rust. Discoloration is not a warrantable item and is a result of improper fuel calibration. This warranty shall be limited to the repair or replacement of the defective part, which may be proven defective under normal use. Rinehart Racing will not warranty any product that has been abused, misused, improperly installed, or modified. Any part that is repaired or replaced under this warranty will, itself, be warrantied only for the remainder of the warranty period of the original product being repaired or replaced. This warranty is non-transferable and is limited to the original retail purchaser.

BUYER'S SOLE AND EXCLUSIVE REMEDY AND RINEHART RACING'S SOLE LIABILITY FOR LOSS OR DAMAGE ARISING FROM PURCHASE OR USE OF THE PRODUCT SHALL BE LIMITED TO REPAIR OR REPLACEMENT OF THE DEFECTIVE PART AT COMPANY'S SOLE DISCRETION. IN NO EVENT SHALL COMPANY BE LIABLE FOR ANY LOSS OF USE, REVENUES, OR ANTICIPATORY PROFIT, OR FOR ANY DIRECT, INDIRECT OR CONSEQUENTIAL DAMAGES ARISING OUT OF OR CONNECTED WITH THE SALE, USE, OPERATION, OR INABILITY TO USE OF PRODUCTS PURCHASED FROM COMPANY TO THE EXTENT PERMITTED BY LAW, COMPANY MAKES NO OTHER REPRESENTATIONS OR WARRANTIES, WHETHER EXPRESSED OR IMPLIED, INCLUDING WITHOUT LIMITATION, WARRANTIES OF MERCHANTABILITY OR FITNESS FOR A PARTICULAR PURPOSE, AND ALL SUCH WARRANTIES ARE EXPRESSLY DISCLAIMED. IN NO EVENT SHALL COMPANY'S LIABILITY EXCEED THE AMOUNT OF THE PARTICULAR DEFECTIVE PRODUCT PAID BY THE PURCHASER. THIS LIMITATION OF LIABILITY SHALL BE APPLICABLE TO ANY CLAIM PRESENTED, WHETHER THE LEGAL THEORY FORMING THE BASIS OF SUCH CLAIM INVOLVES CONTRACT, TORT, NEGLIGENCE, STRICT LIABILITY, STATUTE, REGULATION, CONSUMER PROTECTION LAWS OR OTHERWISE.

Cleaning:

Never use harsh chemicals or any type of abrasive material to clean the chrome or ceramic coating on this exhaust system. We recommend using a soft nonabrasive cloth with a mild detergent.

Proper Use of Product as Designed, Intended and Manufactured by Manufacturer:

The Limited Warranty as described herein applies only when the Rinehart Racing™ system is installed correctly and used for its intended purpose. Warranty does not apply when damage is the result of normal wear and tear, improper use, neglect or incorrect engine calibration or tuning. Rinehart Racing™ mufflers are designed to be installed and used as originally assembled by the manufacturer. Modifying or removing the Rinehart Racing™ baffle may result in decreased performance and discoloration and furthermore, such action shall void the warranty. DO NOT remove the original baffle unless it is being replaced with an alternate Rinehart Racing™ baffle that is designed and intended for use on the specific model/make motorcycle being altered. UNDER NO CIRCUMSTANCES should a Rinehart Racing™ muffler be used without a proper baffle contained within the muffler. Doing so shall void the Limited Warranty as described herein. See Warranty Notice above for more information. Rinehart Racing™ Mufflers are designed and intended for use ONLY on Rinehart Racing™ head pipes. Use and installation of Rinehart Racing™ Mufflers on any alternate aftermarket head pipe is strictly prohibited and is likely to result in discoloration which is not a warrantable item. Improper use of Rinehart Racing™ product, including but not limited to head pipes and mufflers, is strictly prohibited and will void the Limited Warranty as described herein. See Warranty Notice above for more information.

Provided Hardware

1 – (35-00038) - 3/8" Carriage Bolt	1-(29-00028B) – ½" Front Floorboard Spacer
1 – (35-00039) - 3/8" Nut	1-(29-00300B) – ½" Front Floorboard Peg Spacer
2 – (20-00003) - Exhaust gasket	1-(35-00308) – 3/8"-16 x 3.25" SHCS
2 – (35-00083BA) - 18mm bung plug	1-(35-00306) – 3/8"-16 x 1.75" SHCS
2 – (35-00085BA) - 12mm bung plug	1-(29-00303) –1/4" Spacer
1 – (31C150KCSOZ) - 5/16-18 X 1-1/2 SHCS Zinc Plated	1- (31NWSA0Z) - 5/16 SA Flat Washer Zinc
1—(31NLOC0Z) - 5/16 Split Lock Washer Zinc	
1 – (Slimline Bracket) - Cross Under Bracket	

Installation Instructions

*****Disconnect negative battery terminal before starting any work.*****

- 1) Remove left and right saddlebags.
- 2) Remove right side front floorboard. **(Figure 1)**
- 3) Remove mufflers and save for later installation.
- 4) Loosen the exhaust clamp and remove the support clamp for the left exhaust pipe. The support clamp is located under the transmission pan. **(Figure 2)**
- 5) Remove the cross under exhaust pipe and stock mounting bracket. Install the new mounting bracket using the OEM bolts. **(Figure 3)**
- 6) Remove the carriage bolt and nut from the transmission support tab located on the right side of the motorcycle. Save for installation of new header.
- 7) Loosen and remove the exhaust flange nuts and remove the OEM exhaust. On 2017 and later bikes remove the stud from the side of the motor case.
- 8) Carefully remove the O2 sensors from the OEM exhaust. Remember to note which sensor came from which header. Gray wire sensor is for the front header. Black wire sensor is for the rear header.
- 9) Carefully remove OEM exhaust flanges and retaining rings. Do not damage or distort the retaining rings. If possible use snap ring pliers. Replace damaged retaining rings.
- 10) Slide the exhaust flange and retainer rings onto the RINEHART exhaust headers. The machined recess should face the retainer ring.
- 11) Remove the OEM exhaust gaskets from the cylinder heads. It may be necessary to pry the exhaust gaskets from the head using a scribe or a small screwdriver. Do not damage the cylinder head!
- 12) Install supplied exhaust gaskets; make sure to seat the new gaskets into the cylinder head. Failure to use provided gaskets WILL alter the fitment of the system.
- 13) If applicable, install both OEM O2 sensors into the front and rear Rinehart pipes. Torque 25 ft. lbs. Apply anti-seize (anti-seize is not provided) on O2 sensor threads before installing. (Do not get any anti-seize on O2 sensor tips.) Reconnect O2 sensor cables back into appropriate terminals.

- 14) Install the Rinehart Slimline header. Place in the front cylinder head first. It may be necessary to pull rearward slightly on the header to get it in the rear cylinder head. Finger-tighten the exhaust head flange nuts.
- 15) For the 2016 and back bikes reinstall the carriage bolt and nut through the P-clamp and transmission support bracket located on the right side of the motorcycle just below the transmission cover using the OEM 3/8 carriage bolt and nut. Both flanges of the P-clamp should be located under the stock bracket. For the 2017 and up bikes install the 1/4" spacer behind the pre-installed mounting bracket. Using the 5/16-18 bolt, flat and lock washer, secure the bracket using the mounting hole that the stud was removed earlier.
- 16) Install the barrel clamp and bracket on the cross under tube, slide fully onto main header and snug the barrel clamp. Insert the supplied carriage bolt through both brackets so the threads face the rear tire and install nut. **(Figure 4)**
- 17) With everything finger tight, install mufflers on the header and rear mounting brackets. Check to verify the muffler clamps are flush with the inlet to ensure a proper seal on the header.
- 18) IN THIS ORDER!!! Tighten the cylinder head exhaust flange nuts. Torque to 10-12ft lbs. Tighten barrel clamp on cross under tube. Tighten both carriage bolts and nuts to 15-20 lbs-ft. Tighten muffler clamps and rear mounting hardware on mufflers. Torque 8-10ft lbs.
- 19) Install right hand floor board using 3/8"-16x 3.25" bolt, OEM nut, and 1/2" round spacer for the front (place between frame and floorboard), and 3/8 – 16 x 1.75" and peg spacer for the rear bolt.
- 20) After the installation of the exhaust system, make sure to use an appropriate cleaner and microfiber cloth and wipe the surface clean before starting. Any marks left on the exhaust system will be permanently etched into the surface of the system if left on during the first heat cycle.



FIGURE 1

Harley Davidson FL Touring 2009 - current

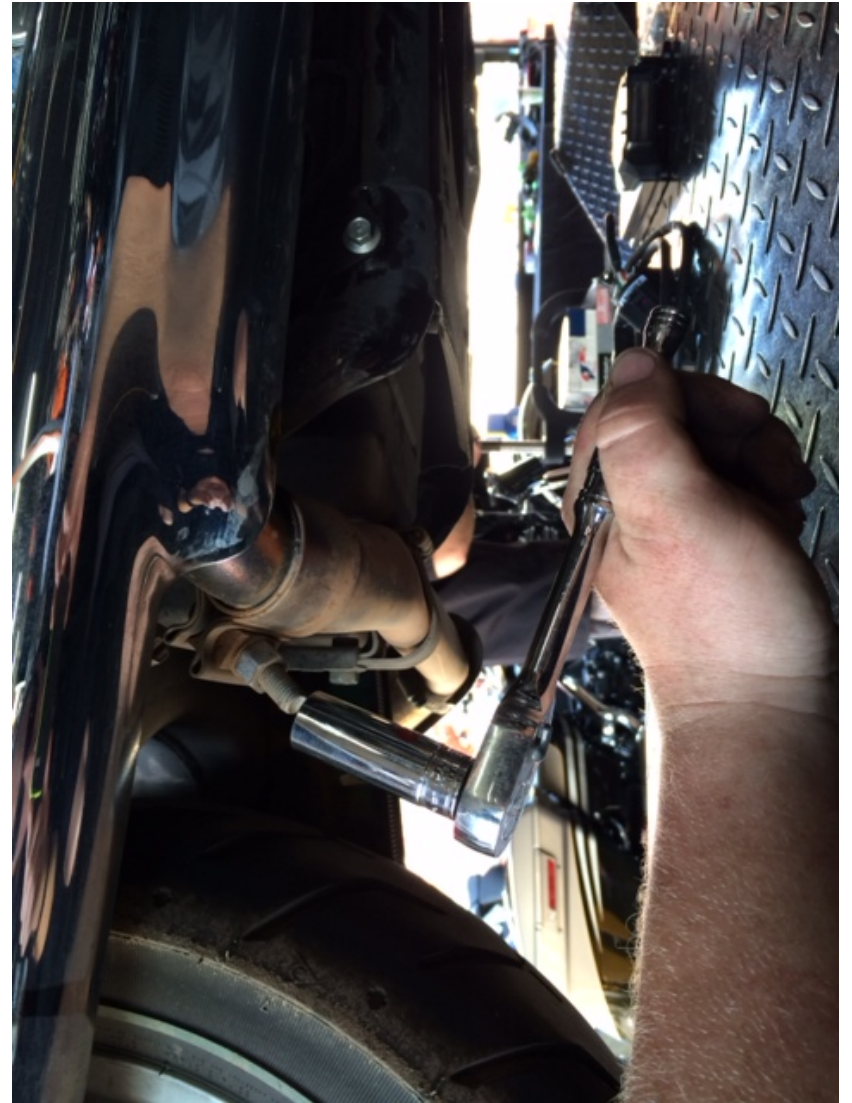

FIGURE 2

Slimline Duals

HK-Slimline



FIGURE 3

Harley Davidson FL Touring 2009 - current



FIGURE 4

Slimline Duals

HK-Slimline

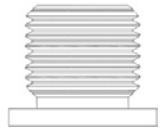
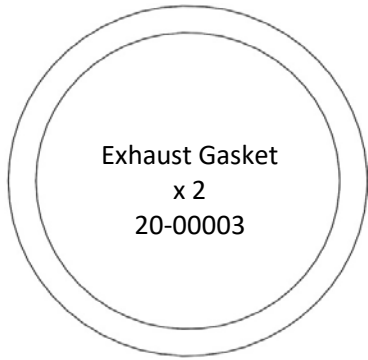

18 mm
O2 Bung Plug
x 2
35-00084BA



12 mm
O2 Bung Plug
x 2
35-00085BA

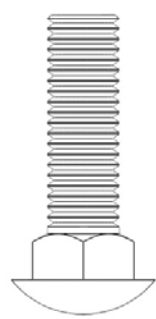

3/8" x 1-1/4"
Carriage Bolt
x 1
35-00038

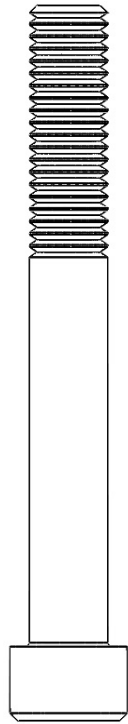

3/8" x 3-1/4"
Socket Head Cap Screw
x 1
35-00308

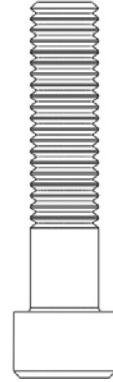

3/8" x 1-3/4"
Socket Head Cap Screw
x 1
35-00306

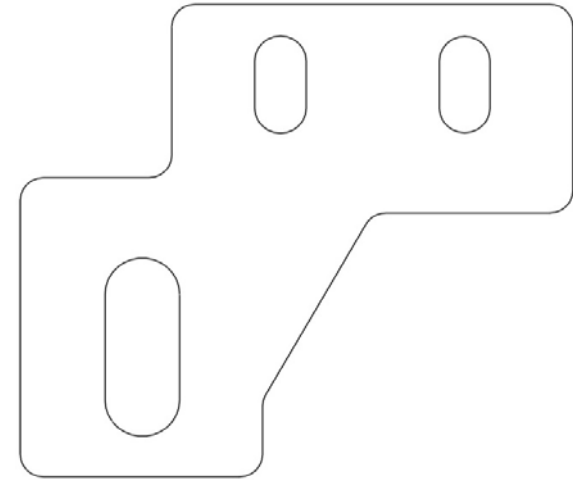

Slimline Crossunder Bracket
x 1



3/8"
Serrated Flange Nut
x 1
35-00039



1/2"
Front Floorboard Spacer
x 1
29-00028B



1/2"
Front Floorboard Peg Spacer
x 1
29-00300B