



WWW.TWOBROS.COM  
401 S. GRAND AVE., SANTA ANA, CA 92705 - (800) 211-2767

# HONDA GROM

Full System Part # 005-4540105-T

# TARMAC



1	Muffler Canister	Tarmac
1	Header	005-45401H
1	8x55mm Socket Head Cap Screw	005-SH855
1	8mm Nylon Lock Nut	005-NN8
2	8mm Large O.D. Flat Washers	005-WO8
1	18mm Aluminum Spacer	005-S-18
1	Hardmount Spacer (Nylon)	005-454-S1
2	45mm Swivel Hook Spring	005-S45
1	Spring Puller	005-SP
1	Anti-Seize	031-P09175
1	TBR Sticker Kit	015-10212

## IMPORTANT - PLEASE READ CAREFULLY

We recommend that this performance part be installed by a qualified motorcycle technician. If you have any doubts as to your ability to install this performance part, please consult with your local motorcycle dealer. Read all instructions first before starting installation. Make sure the motorcycle and exhaust system are completely cool before starting the installation. Also, make sure the bike is secure on a centerstand or ideally a service lift during installation. Be sure to save all stock components for possible use later.

## WARRANTY

Two Brothers Racing products are intended for closed course competition purposes only, and therefore are sold "as is" without warranty. Two Brothers Racing specifically disclaims any warranties of merchantability or fitness for a particular purpose and disclaims all responsibility for consequential and incidental damages or any other losses arising from the use of these products or parts.

## INSTALLATION INSTRUCTIONS

1. Make sure the motorcycle is completely cool before installation, and make sure it is secure on a stand or service lift.

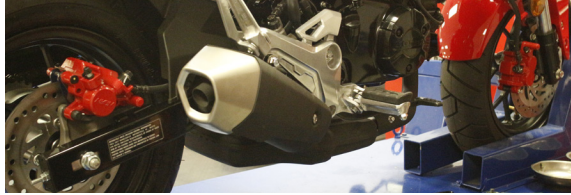

2. Remove exhaust flange nuts located at cylinder head. Retain these nuts for use with TBR exhaust system.

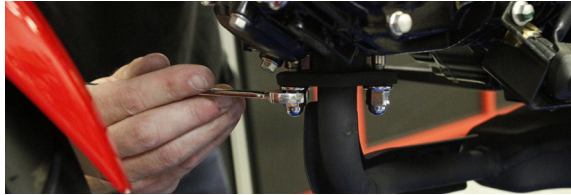

3. Remove bolt located on top of the OEM muffler.

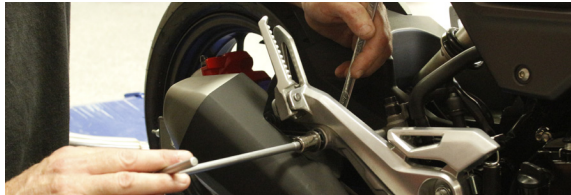

4. Remove two bolts where OEM exhaust is fastened to the frame underneath motorcycle (One bolt on each side of motorcycle). Support exhaust system while removing these bolts. Once these bolts are removed, OEM exhaust can be removed from motorcycle.

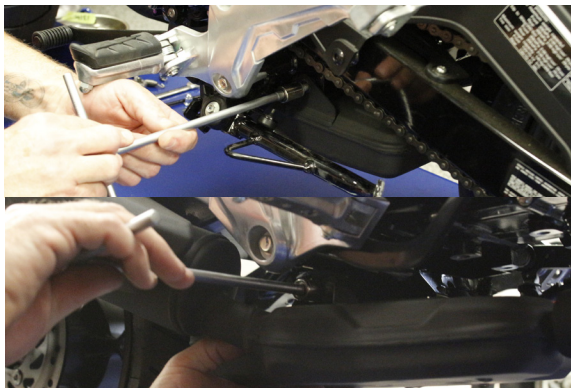

5. Remove hat washer and rubber grommet from OEM muffler mount.

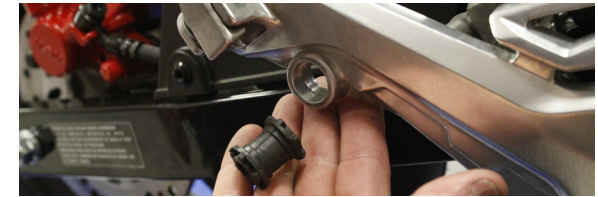

6. Install TBR head pipe using OEM flange nuts. NOTE: only thread nuts on far enough to support head pipe for now... do not tighten.

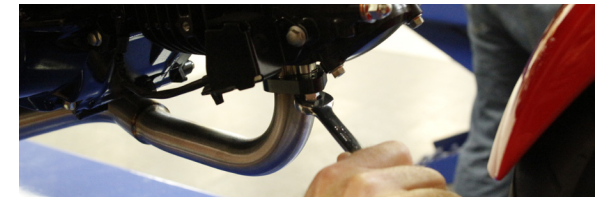

7. Apply a small amount of Anti-Seize on inside of Tarmac muffler inlet, and slide it onto head pipe.



8. Bolt TBR Tarmac muffler to OEM muffler mount using supplied hardware... (Slide bolt through one of the flat washers, then through the mount on the TBR Tarmac muffler, then slide aluminum spacer onto bolt, and then smaller nylon spacer onto bolt, then put bolt through OEM muffler mounting bracket, making sure nylon spacer slides into OEM mounting hole, then install other supplied flat washer and nylock nut to backside of OEM mount, and leave this assembly loose for now).



WWW.TWOBROS.COM  
401 S. GRAND AVE., SANTA ANA, CA 92705 - (800) 211-2767

**HONDA GROM**  
Full System Part # 005-4540105-T

**TARMAC**



1	Muffler Canister	Tarmac
1	Header	005-45401H
1	8x55mm Socket Head Cap Screw	005-SH855
1	8mm Nylon Lock Nut	005-NN8
2	8mm Large O.D. Flat Washers	005-WO8
1	18mm Aluminum Spacer	005-S-18
1	Hardmount Spacer (Nylon)	005-454-S1
2	45mm Swivel Hook Spring	005-S45
1	Spring Puller	005-SP
1	Anti-Seize	031-P09175
1	TBR Sticker Kit	015-10212

## INSTALLATION INSTRUCTIONS

## CARE & CLEANING

### Care & Cleaning

Keep system free of dirt and moisture. Store in a cool, dry place. Make sure vehicle is completely cool before maintenance.

**Stainless Header System:** Polished stainless steel pipes will turn a light golden hue after a few heat cycles, this is a normal characteristic of high quality stainless steel. Clean using a mild water based spray cleaner. Always apply cleaner or polish with a soft, clean cloth.

**Titanium Header System:** Polished titanium pipes will experience color shift ranging from deep blue/purple through amber after a few heat cycles. This is a normal characteristic of high quality titanium. Clean using a mild water based spray cleaner. Always apply cleaner or polish with a soft, clean cloth.

**Polished Aluminum Canisters:** Use an aluminum or mag wheel polish to restore the bright finish to factory spec.

**Brushed Aluminum Canisters:** Clean using a mild water based spray cleaner. Always apply cleaner or polish with a soft, clean cloth.

**Carbon Fiber Canisters:** Clean using a mild water based spray cleaner. Always apply cleaner or polish with a soft, clean cloth. Always make sure the fiberglass packing inside is in good condition and not burned out, as exhaust heat inside an empty canister will deteriorate the carbon fiber sleeve. TBR sells repack kits (Road - #005-10038, Offroad - #005-10038MX) that include everything you need to easily do it yourself.

**Titanium Mufflers:** For cleaning use a mild water based spray cleaner. Always apply cleaner or polish with a soft, clean cloth. Always make sure the fiberglass packing inside is in good condition and not burned out, as exhaust heat inside an empty canister will deteriorate the carbon fiber sleeve. TBR sells repack kits (Road - #005-10038, Offroad - #005-10038MX) that include everything you need to easily do it yourself.

Repack all road canisters at the first signs of packing material deterioration. Part #005-10038  
Repack all offroad canisters after every 10 hours of use. Part #005-10038MX

**NEVER** dyno test your bike with carbon fiber or titanium canisters installed - the intense heat and lack of cooling air can quickly burn through the canister material. Two Brothers Racing does not provide a warranty for burned canisters.



9. Install supplied retention springs.



10. Now go back and tighten flange nuts, making sure head pipe flange is centered in cylinder head.

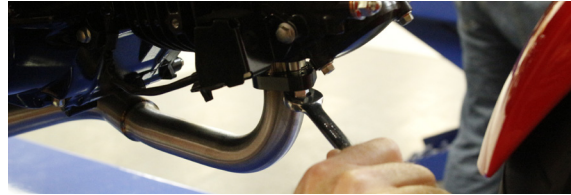

11. Next tighten muffler mount bracket assembly.

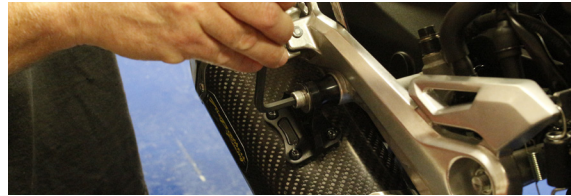

12. Double check your work to make sure everything is secure.

13. Before you run the motorcycle, clean off all fingerprints and dirt, as any oily residue will etch the metal and become somewhat permanent when the