



**Table 1** DYNA MOUNTING HARDWARE

ITEM NO.	DESCRIPTION	QTY.
1	3/8"-16 x 1.75" BHCS	2
2	3/8"-16 x 1.25" BHCS	2
3	.625" SPACER	2
4	.190" SPACER	2

**Disclaimer:** This installation should be performed by an experienced mechanic who has access to a factory service manual and all required tools.

Incorrect installation can cause damage not covered under warranty. Failure to install components correctly CAN result in serious injury to motorcycle, operator, passenger, and/or others.

**Note:** See table 1 for correct mounting hardware.

**Step 1:** Install hard mount plate using 3/8"-16 x 1.25" BHCS and .190" spacers for forward mounting holes and 3/8"-16 x 1.75" BHCS with .625" spacer for the rear mounting holes. **(Figure 1)**

**Step 2:** Slide throw over sleeve through slot and tighten down the clamp using the supplied carriage bolts and lock nuts. **(Figure 3)**

**Step 3:** Verify that all hardware is properly tightened.

**Step 4:** Ensure there is proper clearance between brake caliper, rotor, swing arm and the bag mount.

**Step 5:** Secure lower straps to mounting bracket as shown in figure 3.

**Step 6: GO RIDE!**

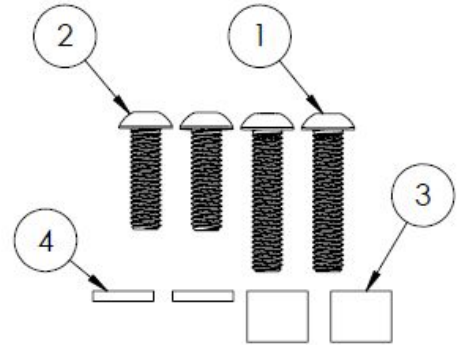

**Figure 1**

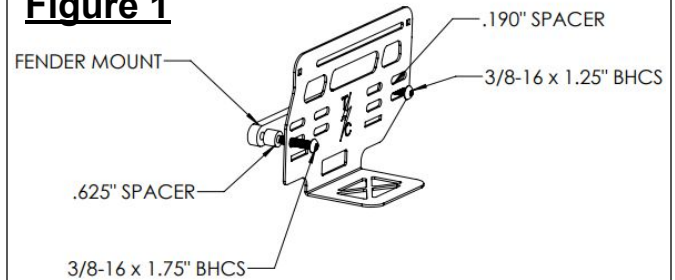

**Figure 2**



**Figure 3**

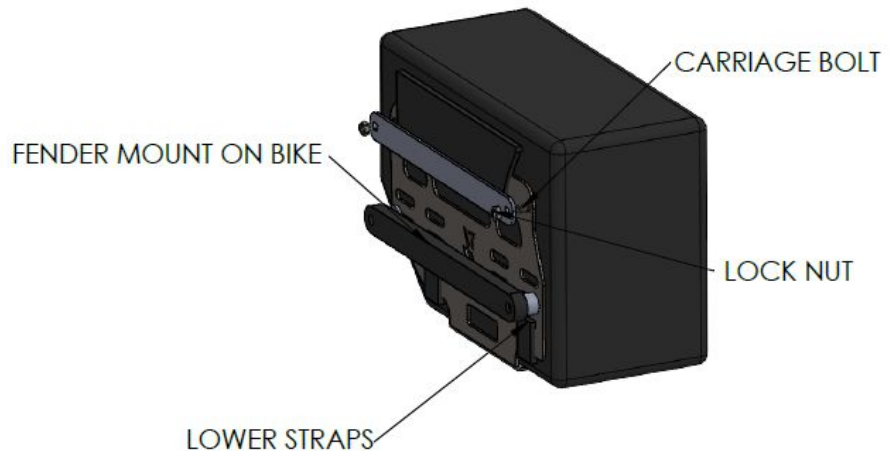
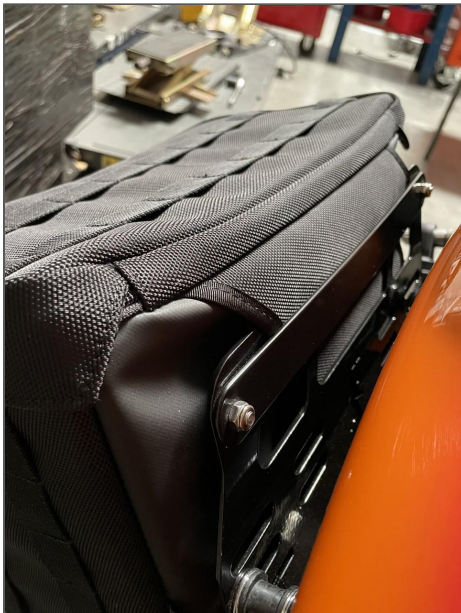



**Table 2** SOFTAIL MOUNTING HARDWARE

ITEM NO.	DESCRIPTION	QTY.
1	.190 SPACER	4
2	3/8"-16 x 1.25" BHCS	4

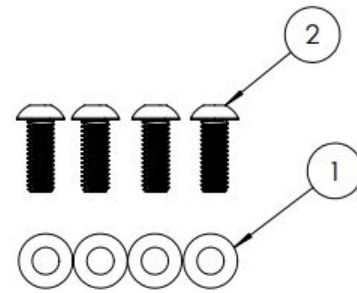

**Disclaimer:** This installation should be performed by an experienced mechanic who has access to a factory service manual and all required tools.

Incorrect installation can cause damage not covered under warranty. Failure to install components correctly CAN result in serious injury to motorcycle, operator, passenger, and/or others.

**Note:** See table 2 for correct mounting hardware.

**Step 1:** Install hard mount plate using 4x 3/8"-16 x 1.25" BHCS and .190" spacers. **(Figure 1)**

**Step 2:** Slide throw over sleeve through slot and tighten down the clamp using the supplied carriage bolts and lock nuts. **(Figure 3)**

**Step 3:** Verify that all hardware is properly tightened.

**Step 4:** Ensure there is proper clearance between brake caliper, rotor, swing arm and the bag mount.

**Step 5:** Secure lower straps to mounting bracket as shown in figure 3.

**Step 6: GO RIDE!**

**Figure 1**

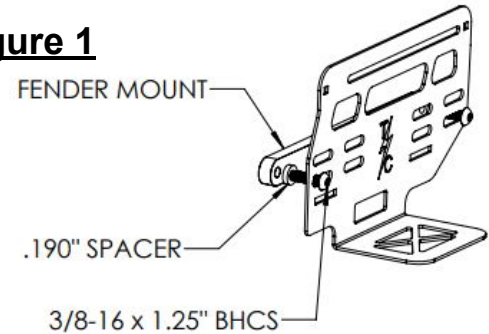

**Figure 2**



**Figure 3**

